

**CITY OF LA VISTA
MAYOR AND CITY COUNCIL REPORT
JUNE 17, 2025 AGENDA**

Subject:	Type:	Submitted By:
ADVERTISEMENT FOR BIDS – 99 th Street AND GILES RD INTERSECTION IMPROVEMENTS	◆ RESOLUTION ORDINANCE RECEIVE/FILE	PAT DOWSE CITY ENGINEER

SYNOPSIS

A resolution has been prepared to authorize the advertisement for bids for the construction of a traffic signal, pedestrian push buttons, and ADA curb ramp reconstruction at the intersection of 99th Street/Val Verde Drive and Giles Road.

FISCAL IMPACT

The FY25/FY26 Biennial Budget provides funding for this project.

RECOMMENDATION

Approval.

BACKGROUND

In preparation for the construction of the Sagebrook development, generally located on the northwest corner of 96th Street and Giles Road, a traffic impact analysis was conducted. The traffic analysis showed that upon completion of the Sagebrook development, the intersection of 99th Street/Val Verde Drive and Giles Road would warrant a traffic signal. As part of the Sagebrook Conditional Use Permit (CUP), the development is to pay 25% of the costs of the improvements.

It is anticipated that the combination mast arm, signal, and lighting poles will have a variable production lead time and the provisions of the contract stipulate the contractor will complete all work within 30 days of receiving the poles, which would put the estimated project completion into the Fall of 2025.

Preparation of plans and specifications for this project have been completed by Felsburg, Holt and Ullevig (FHU). The Engineer's Estimate for the proposed items of work is \$499,288.00. The recommended schedule for bidding this work is:

Publish Notice to Contractors
Open Bids
Council Award Contract

June 25, and July 2, 2025
Wednesday, July 9, 2025, at 10:00 am, City Hall
July 15, 2025

The Notice to Contractors will also be posted on the City's web site and at www.standardshare.com. A copy of the Notice to Contractors is attached.

RESOLUTION NO. _____

A RESOLUTION OF THE MAYOR AND CITY COUNCIL OF THE CITY OF LA VISTA, NEBRASKA AUTHORIZING THE ADVERTISEMENT FOR BIDS FOR THE 99TH STREET AND GILES ROAD INTERSECTION IMPROVEMENTS.

WHEREAS, the Mayor and Council have determined that the 99th Street and Giles Road Intersection Improvements; and

WHEREAS, the FY25/FY26 Biennial Budget provides funding for this project; and

WHEREAS, the schedule for awarding this contract is as follows:

Publish Notice to Contractors	June 25, 2025 and July 2, 2025
Open Bids	July 9, 2025 at 10:00am at City Hall
City Council Award Contract	July 15, 2025

NOW, THEREFORE BE IT RESOLVED, that the Mayor and City Council of the City of La Vista, Nebraska hereby authorize the advertisement for bids for the 99th Street and Giles Road Intersection Improvements.

PASSED AND APPROVED THIS 17TH DAY OF JUNE 2025.

CITY OF LA VISTA

Douglas Kindig, Mayor

ATTEST:

Rachel D. Carl, CMC
City Clerk

COMPUTER: GX36

DATE: 6-JUN-2025 08:38

FILE: 124434 Sheets Title.dgn

CITY OF LA VISTA

PUBLIC WORKS DEPARTMENT

99TH ST. AND GILES RD.

INTERSECTION IMPROVEMENTS

PAVING, GRADING, SIGNING, AND TRAFFIC SIGNAL

FINAL PLANS - JUNE 2025

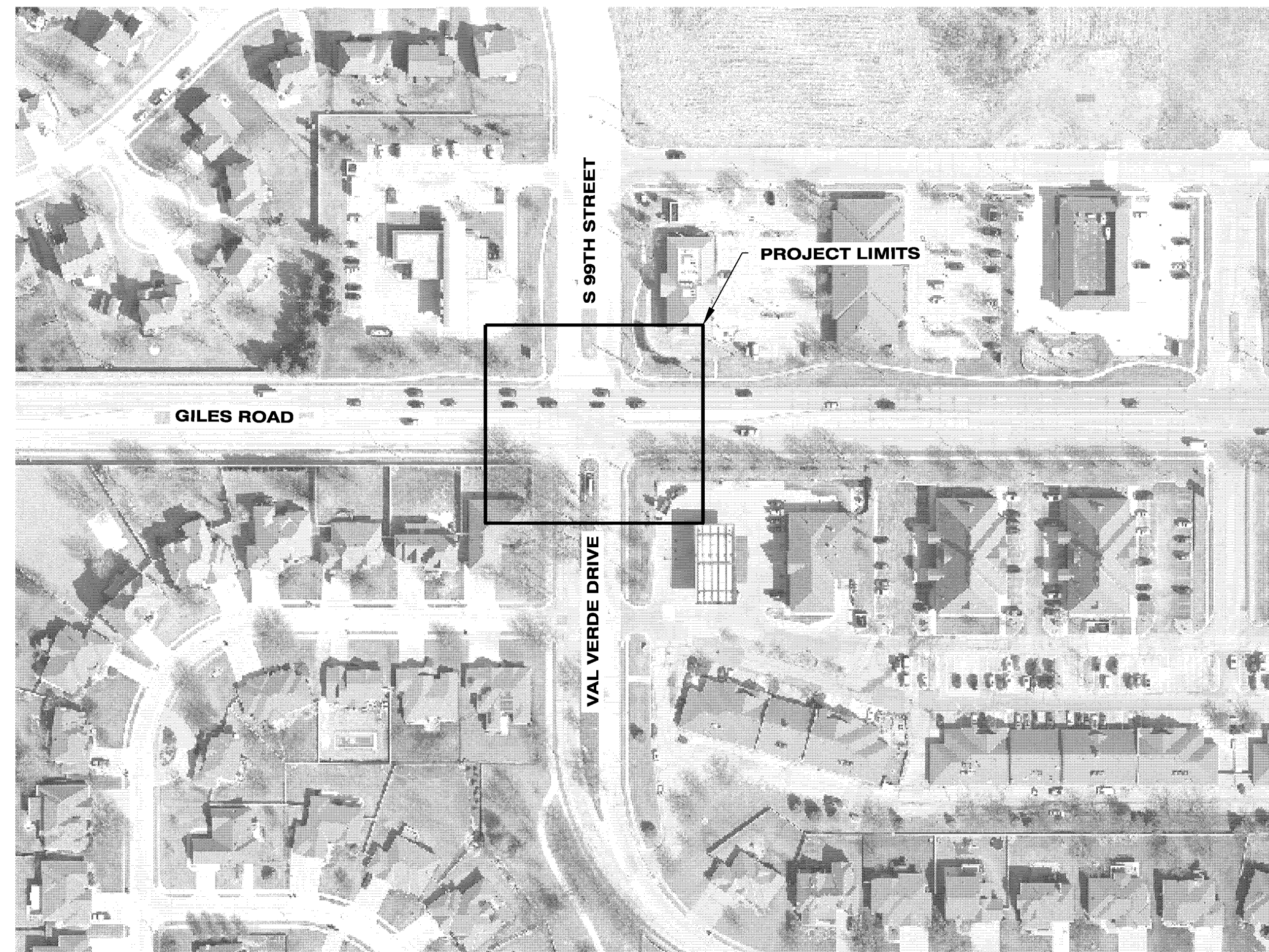

INDEX OF SHEETS

1	TITLE SHEET
2	GENERAL NOTES & SUMMARY OF QUANTITIES
3	AERIAL
4	REMOVALS
5	CONSTRUCTION
6	GEOMETRICS
7	JOINTS & GRADES
8	SIGNING & STRIPING
9 - 11	TRAFFIC SIGNAL
12	EROSION CONTROL
13 - 14	RIGHT-OF-WAY

THE FOLLOWING 2020 STANDARD PLATES ON FILE AT THE CITY OF
OMAHA PUBLIC WORKS DEPARTMENT SHALL GOVERN:

ITEMS	STANDARD PLATE NUMBER
INLET PROTECTION	101-03
CONCRETE WASHOUT	101-06
CONCRETE PAVEMENT JOINT DETAILS	501-01
CONCRETE PAVEMENT WIDENING & MISC. DETAILS	501-02
CONCRETE CURBS	502-01
SIDEWALK CONSTRUCTION	503-01
SIDEWALK LOCATION	503-02
CONCRETE MEDIANS	503-04
CONCRETE CURB RAMPS	504-01

THE CITY OF OMAHA STANDARD SPECIFICATIONS FOR PUBLIC WORKS
CONSTRUCTION 2020 AND THE SPECIAL PROVISIONS APPLY TO THIS PROJECT.

LEGEND

EXISTING	PROPOSED
CENTER LINE	PROPOSED SEWER LINE
PROPERTY LINE	STREET REMOVAL
FENCES	DRIVEWAY REMOVAL
FIRE HYDRANT	SIDEWALK REMOVAL
INLET-GRATE	CURB INLETS
INLET-TYPE "A"	GRATE INLETS
WATER MANHOLE	INVERT ELEVATIONS
SEWER MANHOLE	PROPOSED SANITARY MANHOLE
POWER MANHOLE	PROPOSED STORM MANHOLE
POWER POLE	COORDINATE LOCATIONS
POWER AND LIGHT POLE	7" CONCRETE PAVEMENT
LIGHT POLE	10" CONCRETE PAVEMENT
STREET SIGN (S)	9" CONCRETE BASE
RETAINING WALL	10" CONCRETE BASE
OVERHEAD POWER CABLE	10" CONCRETE BASE TYPE LBS
UNDERGROUND POWER CABLE	7" CONCRETE DRIVEWAY
OVERHEAD TELEPHONE CABLES	2" ASPHALT SURFACE COURSE, TYPE CMM, PG 70-28
WATER MAIN	COLD PLANING - ASPHALT
GAS MAIN	COLD PLANING - CONCRETE
AT&T LINE	
EXISTING SEWER W/ SIZE	
GAS METER	
WATER METER	
EXISTING ELEVATION	



PRIOR TO CONSTRUCTION:

CALL: 1-800-331-5666 OR 811 FOR LOCATION OF UNDERGROUND
TELEPHONE, ELECTRIC, GAS MAINS, CABLEVISION AND CITY OF
OMAHA UTILITIES.

NOTE: EXISTING UNDERGROUND AND OVERHEAD UTILITIES AND
DRAINAGE STRUCTURES HAVE BEEN PLOTTED FROM AVAILABLE
INFORMATION AND THEREFORE, THEIR LOCATIONS MUST BE
CONSIDERED APPROXIMATE ONLY. IT IS THE RESPONSIBILITY OF
THE INDIVIDUAL CONTRACTORS TO EXACTLY LOCATE AND PROTECT
EACH EXISTING UTILITY BEFORE AND DURING ACTUAL
CONSTRUCTION.

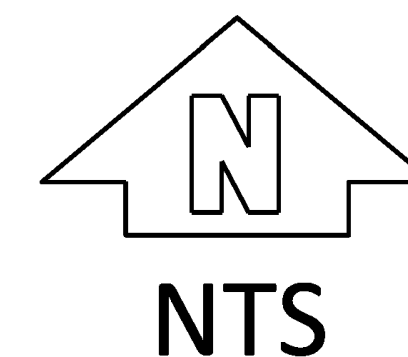

PROJECT #STRT25005

DESIGNED BY: FELSBURG HOLT & ULLEVIG	DATE: 6/6/2025	DRAWN BY: FELSBURG HOLT & ULLEVIG
DESIGN ENGINEER: CONNOR GILINSKY	DATE:	SURVEYED: R.W. (2025)
CITY ENGINEER: PAT DOWSE	DATE:	FIELD BOOK NO.:
SENT: RECEIVED:	SENT: RECEIVED:	SENT: RECEIVED:
SENT: RECEIVED:	SENT: RECEIVED:	SENT: RECEIVED:
SE 1/4 SECTION 16-14N-12E	NE 1/4 SECTION 21-14N-12E	SHEET 1 OF 14

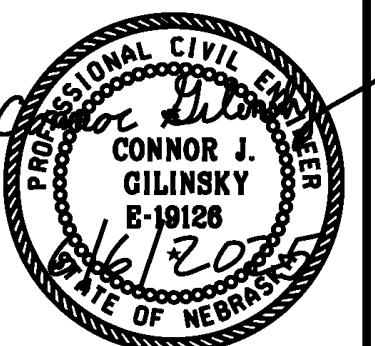

TITLE SHEET

COMPUTER: GX36

DATE: 6-JUN-2025 08:38

FILE: 124434 Sheets General Info.dgn

BID ITEM NUMBER	ITEM NUMBER	ITEM DESCRIPTION	UNIT	QTY
1	101.003	INSTALL CURB INLET PROTECTION	EA	3
2	102.000	CLEARING AND GRUBBING – GENERAL	LS	1
3	105.100	REMOVE PAVEMENT	SY	178
4	105.140	REMOVE SIDEWALK	SF	1310
5	105.150	REMOVE MEDIAN SURFACING	SF	85
6	9000.001	REMOVE LIGHT POLE	EA	4
7	202.100	SUBGRADE PREPARATION	SY	188
8	501.004	CONSTRUCT 10" PCC PAVEMENT (OPW–3500)	SY	188
9	503.002	CONSTRUCT 6" PCC SIDEWALK	SF	1467
10	503.202	CONSTRUCT 6" IMPRINTED PCC SURFACE	SF	292
11	503.300	CONSTRUCT PCC MEDIAN SURFACING	SF	24
12	504.000	CONSTRUCT PCC CURB RAMP	SF	260
13	504.100	CONSTRUCT DETECTABLE WARNING PANEL	SF	64
14	803.206	INSTALL ROLLED EROSION CONTROL, TYPE II WITH SEEDING – TYPE A	SY	410
15	901.007	FURNISH & INSTALL MAST ARMS SIGNAL POLE, TYPE MP–45	EA	1
16	901.047	FURNISH & INSTALL COMBINATION MAST ARM SIGNAL & LIGHTING POLE, TYPE CMP–35–12–40	EA	1
17	901.051	FURNISH & INSTALL COMBINATION MAST ARM SIGNAL & LIGHTING POLE, TYPE CMP–40–12–40	EA	1
18	901.052	FURNISH & INSTALL COMBINATION MAST ARM SIGNAL & LIGHTING POLE, TYPE CMP–45–12–40	EA	1
19		FURNISH & INSTALL PEDESTAL POLE, TYPE PP–4	EA	4
20	901.104	FURNISH & INSTALL PEDESTAL POLE, TYPE PP–10	EA	4
21		FURNISH & INSTALL GPS MODULE	EA	2
22	901.110	FURNISH & INSTALL VIBRATION MITIGATION DEVICE	EA	2
23	901.106	INSTALL LED STREET LIGHT LUMINAIRE	EA	3
24	902.001	FURNISH & INSTALL TRAFFIC SIGNAL, TYPE TS–1 W/T31 FACE, BKPLT & MA–5 MTG	EA	6
25	902.002	FURNISH & INSTALL TRAFFIC SIGNAL, TYPE TS–1A W/T31 FACE & B–4 ALT. MTG	EA	4
26		FURNISH & INSTALL TRAFFIC SIGNAL, TYPE TS–1LFF W/T43F FACE, BKPLT & MA–5 MTG	EA	4
27	902.100	FURNISH & INSTALL PEDESTRIAN SIGNAL, TYPE PS–1 W/T–24 FACE & B–4 ALT MTG	EA	8
28	902.200	FURNISH & INSTALL APS PEDESTRIAN PUSH BUTTON	EA	8
29	902.400	FURNISH & INSTALL 18" STREET NAME SIGN	EA	4
30	903.000	INSTALL TRAFFIC SIGNAL CONTROLLER, TYPE M–60 WITH TRAFFIC SIGNAL CABINET 332L	EA	1
31	904.002	FURNISH & INSTALL PULL BOX, TYPE PB–6	EA	4
32	904.004	FURNISH & INSTALL PULL BOX, TYPE PB–8	EA	1
33	904.020	FURNISH & INSTALL 2" PVC CONDUIT – TRENCHED	LF	385
34	904.031	FURNISH & INSTALL 3" PVC CONDUIT – BORED	LF	910
35	904.041	FURNISH & INSTALL 7/C NO. 14 AWG TRAFFIC SIGNAL CABLE	LF	580
36	904.043	FURNISH & INSTALL 16/C NO. 14 AWG TRAFFIC SIGNAL CABLE	LF	570
37	904.070	FURNISH & INSTALL SERVICE CABLE	LF	60
38	904.080	FURNISH & INSTALL 2/C NO. 16 AWG PEDESTRIAN PUSH BUTTON LEAD–IN CABLE	LF	1155
39	904.100	FURNISH & INSTALL 3/C NO. 6 STREET LIGHTING CABLE	LF	315
40	904.090	FURNISH & INSTALL 1/C NO. 6 BARE COPPER GROUNDING CONDUCTOR	LF	805
41	904.110	FURNISH & INSTALL SERVICE ENTRANCE CABLE	LF	660
42	905.051	INSTALL PERMANENT PREFORMED TAPE MARKING – TYPE 4 GROOVED, 5" WHITE	LF	100
43	905.091	INSTALL PERMANENT PREFORMED TAPE MARKING – TYPE 4 GROOVED, 16" WHITE	LF	125
44	905.101	INSTALL PERMANENT PREFORMED TAPE MARKING – TYPE 4 GROOVED, 24" WHITE	LF	400
45	905.151	INSTALL PERMANENT PREFORMED TAPE SYMBOL – TYPE DIRECTIONAL ARROW, WHITE (LT.)	EA	2
46	905.151	INSTALL PERMANENT PREFORMED TAPE SYMBOL – TYPE DIRECTIONAL ARROW, WHITE (ST/RT)	EA	2
47	906.020	FURNISH & INSTALL TRAFFIC POSTS AND SIGNS	EA	2
48	907.000	FURNISH & INSTALL SERVICE DISCONNECT PEDESTAL	EA	1
49	908.000	FURNISH & INSTALL RADAR VEHICLE DETECTION SYSTEM – 4 APPROACH	EA	1
50	1108.100	RENTAL OF DUMP TRUCK	HR	15
51	1108.101	RENTAL OF SKID LOADER	HR	15
52	1108.102	RENTAL OF BACKHOE	HR	15
53	1108.103	RENTAL OF LOADER	HR	15
54	1109.000	MOBILIZATION	LS	1
55	9000.002	INSTALL CONCRETE PAD	EA	1
56	9000.003	TRAFFIC CONTROL	LS	1

GENERAL NOTES

- THE 2024 EDITION OF THE "CITY OF OMAHA STANDARD SPECIFICATIONS FOR PUBLIC WORKS CONSTRUCTION" AND ANY CURRENT REVISIONS OR UPDATES THERETO SHALL APPLY TO THIS PROJECT AND THE CONTRACTOR SHALL PERFORM IN ACCORDANCE THEREWITHIN.
- THE "OMAHA REGIONAL STORM WATER DESIGN MANUAL" SHALL APPLY TO THIS CONSTRUCTION.
- THE COST OF SHEETING, SHORING OR BRACING AND DEWATERING REQUIRED TO CONSTRUCT THIS PROJECT SHALL BE SUBSIDIARY TO ITEMS FOR WHICH DIRECT PAYMENT IS MADE.
- THE CONTRACTOR IS RESPONSIBLE TO INSURE ALL EXCAVATIONS ARE MADE IN ACCORDANCE WITH THE OCCUPATIONAL SAFETY AND HEALTH ADMINISTRATION (OSHA) CONSTRUCTION STANDARDS – 29 CRF PART 1926, SUBPART P–EXCAVATIONS AS PUBLISHED IN THE FEDERAL REGISTER, VOL. 54, 209, TUESDAY, OCTOBER 31, 1989, RULES AND REGULATIONS. IN ADDITION IT SHALL BE THE CONTRACTOR'S RESPONSIBILITY TO BE FAMILIAR WITH OSHA STANDARDS AND REGULATIONS PERTAINING TO ALL ASPECTS OF THE WORK INCLUDING ENTERING CONFINED SPACES.
- THE CONTRACTOR SHALL RESTRICT ALL CONSTRUCTION OPERATIONS TO WITHIN THE PUBLIC RIGHT–OF–WAY AND THOSE CONSTRUCTION AREAS AS ILLUSTRATED ON THE PLAN.
- THE CONTRACTOR SHALL COORDINATE CONSTRUCTION ACTIVITIES IN A MANNER THAT WILL PROVIDE PROTECTION OF EXISTING TREES AND BUSHES. TREES WITHIN THE LIMITS OF CONSTRUCTION TO BE REMOVED ARE NOTED ON PLANS.
- THE LOCATIONS OF ALL UTILITIES ARE SHOWN AS A CONVENIENCE FOR THE CONTRACTOR. NEITHER THE ENGINEER NOR THE CITY GUARANTEE THE ACCURACY OF SUCH INFORMATION. LOCATIONS OF ALL AERIAL AND UNDERGROUND UTILITIES MAY NOT BE INDICATED ON THESE PLANS. UNDERGROUND UTILITIES, WHETHER INDICATED OR NOT, WILL BE LOCATED AND FLAGGED BY THE UTILITY COMPANIES AT THE CONTRACTOR'S REQUEST. NO EXCAVATION WILL BE PERMITTED IN THE AREA OF UNDERGROUND UTILITIES UNTIL ALL FACILITIES HAVE BEEN LOCATED AND IDENTIFIED TO THE SATISFACTION OF ALL PARTIES AND THEN ONLY WITH EXTREME CARE TO AVOID ANY DAMAGE TO THE UTILITIES. ANY UTILITY DAMAGED BY THE CONTRACTOR DUE TO HIS OPERATIONS SHALL BE REPAIRED BY THE CONTRACTOR AT HIS EXPENSE.
- THE CONTRACTOR SHALL BACKFILL COMPLETED PORTIONS OF CONSTRUCTED SEWER AT THE END OF EACH DAY. EXCAVATION TRENCH REMAINING OPEN SHALL NOT EXCEED 25 LF. THE CONTRACTOR SHALL PLACE SNOW FENCE AROUND EXCAVATION REMAINING OPEN.
- THE CONTRACTOR SHALL FURNISH AND MAINTAIN ALL NECESSARY BARRICADES, WARNING SIGNS, LIGHTS AND FLASHERS PER THE MUTCD AND THE OMAHA BARRICADING STANDARDS. THE CONTRACTOR SHALL INSPECT AND VERIFY ALL APPROPRIATE BARRICADES AND SIGNS ARE PLACED ACCORDINGLY AND UPRIGHT AT THE END OF EACH CONSTRUCTION DAY, OR AS DIRECTED BY THE ENGINEER.
- THE CONTRACTOR SHALL NOTIFY CITY REPRESENTATIVE 24 HOURS IN ADVANCE OF ANY SIGNING/STRIPING WORK.
- CONCRETE PAVEMENT SHALL BE CURED USING A WHITE PIGMENTED LIQUID MEMBRANE FORMING CURING COMPOUND THAT HAS BEEN APPROVED BY THE NEBRASKA DEPARTMENT OF TRANSPORTATION. THE MINIMUM RATE OF APPLICATION SHALL BE 200 SQ. FT. PER GAL. IF A MECHANICAL POWERED SPRAYER IS USED, AND 100 SQ. FT. PER GAL. IF A HAND POWERED SPRAYER IS USED. TANK MEASUREMENTS SHALL BE RECORDED.
- THE CONTRACTOR SHALL CONSTRUCT ADA COMPLIANT SIDEWALK RAMPS AT ALL RETURNS WHERE SIDEWALKS ARE REMOVED AND REPLACED.
- A WALK BEHIND SAW WITH A DIAMOND EDGE SAW BLADE SHALL BE USED FOR CUTTING ALL REQUIRED CONTRACTION AND LONGITUDINAL PAVEMENT JOINTS. ALL SAW CUTS (INCLUDING THOSE FULL DEPTH CUTS NECESSARY TO REMOVE PAVEMENT) SHALL BE SUBSIDIARY TO ITEMS FOR WHICH DIRECT PAYMENT IS MADE.
- ANY FITTINGS OR CONNECTIONS REQUIRED TO CONSTRUCT SEWER PIPE SHALL BE SUBSIDIARY TO THE BID ITEMS.
- THE CITY OF OMAHA ENVIRONMENTAL SERVICES SAFETY MANUAL IS AVAILABLE FOR REVIEW UPON REQUEST OF THE CONTRACTOR/SUBCONTRACTOR. THIS MANUAL IS THE CITY OF OMAHA'S SAFETY PLAN FOR EMPLOYEES AND REVIEW OF SAID DOCUMENT DOES NOT RELIEVE CONTRACTORS/SUBCONTRACTOR OF HAVING HIS OWN SAFETY PLAN, PROVIDING PROPER SAFETY EQUIPMENT, AND BEING RESPONSIBLE FOR HIS EMPLOYEES SAFETY IN ACCORDANCE WITH FEDERAL, STATE AND LOCAL REGULATIONS. THE CITY IS NOT RESPONSIBLE FOR CONTRACTOR SAFETY OR OF HIS SUBCONTRACTORS.
- ALL STORM SEWER PIPE SHALL BE INSTALLED WITH CRUSHED ROCK BEDDING AS SHOWN IN THE SPECIAL PLANS. NO RECYCLED PCC OR ASPHALT WILL BE ALLOWED.
- THE CONTRACTOR WILL BE REQUIRED TO FURNISH WASTE AREAS FOR EXCESS EXCAVATION ON THIS PROJECT.
- SIDEWALK REMOVAL AND CONSTRUCTION WILL BE COMPLETED ON ONE SIDE OF ROADWAY AT A TIME. ACCESS TO BUSINESSES SHALL BE MAINTAINED DURING BUSINESS HOURS. PRIOR TO REMOVING EXISTING SIDEWALK THE CONTRACTOR IS TO MEET WITH ALL BUILDING MANAGERS WITHIN THE SIDEWALK REMOVAL AREA AND REVIEW THE PROPOSED WORK. ANY ADDITIONS OR DELETIONS REQUESTED BY THE BUILDING MANAGER SHALL BE REVIEWED AND APPROVED BY THE ENGINEER.
- CRUSHED ROCK SHALL BE UTILIZED AT LOCATIONS WERE TEMPORARY ACCESS NEEDS TO BE PROVIDED.
- GENDER SPECIFIC SIGNS, SUCH AS FLAGMAN AND MEN WORKING, WILL NOT BE ALLOWED. THE SIGNS SHALL EITHER BE NEUTRAL GENDER, SUCH AS FLAGGER, OR EQUIVALENT SYMBOL SIGNS.
- ALL CCTV INSPECTION REQUIRED AS PART OF STORM SEWER OR SANITARY SEWER CONSTRUCTION SHALL BE SUBSIDIARY TO OTHER ITEMS RECEIVING DIRECT PAYMENT.
- CONCRETE WASHOUT STATIONS SHALL BE CONSTRUCTED AS NEEDED DURING THE PAVING OPERATIONS. THIS SHALL BE SUBSIDIARY TO OTHER ITEMS RECEIVING DIRECT PAYMENTS.
- THE CONTRACTOR SHALL BE RESPONSIBLE FOR CAPPING SPRINKLER SYSTEMS THAT ARE IMPACTED DURING THE PROJECT. THIS SHALL BE SUBSIDIARY TO OTHER ITEMS RECEIVING DIRECT PAYMENT.
- ALL ITEMS WITHIN THE LIMITS OF CONSTRUCTION NOT INDICATED IN THE PLANS FOR REMOVAL SHALL BE INCIDENTAL TO THE ITEM "CLEARING AND GRUBBING GENERAL."
- ANY DEWATERING AND/OR BYPASS PUMPING REQUIRED FOR THE CONSTRUCTION OF STORM OR SANITARY SEWERS SHALL BE CONSIDERED SUBSIDIARY TO OTHER BID ITEMS RECEIVING DIRECT PAYMENT UNLESS INDICATED OTHERWISE IN THE CONTRACT.
- TEMPORARY FENCE SHALL BE INSTALLED AT LOCATIONS WHERE FENCE IS BEING REMOVED AS INDICATED IN CONTRACT AND REPLACED AS PART OF THE CONSTRUCTION. THE TEMPORARY FENCE SHALL BE CHAIN LINK AND SHALL BE A MINIMUM OF FOUR FEET HIGH. THE TEMPORARY FENCE SHALL BE CONSTRUCTED IN SUCH A MANNER SO AS TO COMPLETELY SECURE THE ENCLOSED AREA FOR PET AND HUMAN PROTECTION.
- MOWING WITHIN THE PROJECT LIMITS DURING CONSTRUCTION SHALL BE THE RESPONSIBILITY OF THE CONTRACTOR. MOWING SHALL BE SUBSIDIARY TO ITEMS FOR WHICH DIRECT PAYMENT IS MADE.
- THE CONTRACTOR SHALL ADJUST ALL NEW AND EXISTING INLETS, VALVE BOXES, MANHOLE RIMS, AND SEWER CLEAN OUTS, ETC. TO FINISH GRADE AS APPLICABLE WHERETHER OR NOT THEY ARE SHOWN ON THE PLANS.
- THE CONTRACTOR SHALL MAINTAIN DRAINAGE AND PROVIDE TEMPORARY PATHS OR MEANS FOR DRAINAGE DURING INSTALLATION OF SEWER OR DRAINAGE INFRASTRUCTURE.
- REMOVAL OF SIGNS IS SUBSIDIARY TO THE BID ITEM "REMOVE LIGHT POLE"
- MINOR EARTHWORK REQUIRED IS SUBSIDIARY TO THE BID ITEM "SUBGRADE PREPARATION"

FELSBURG
HOLT &
ULLEVIG

14606 Branch St., Ste 400
Omaha, NE 68154
Office: 402-445-4405
Nebraska C.O.A. #CA-2681

Project Number

20241203

99TH & GILES ROAD
CURB RAMPS AND
SIGNAL DESIGN

GENERAL NOTES & SUMMARY OF QUANTITIES

FELSBURG
HOLT &
ULLEVIG

Roadway
Design
Division

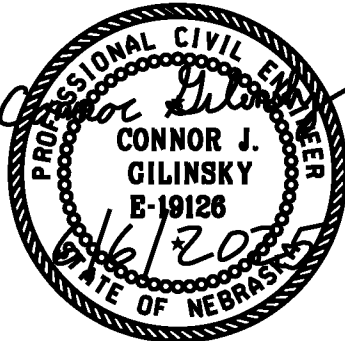

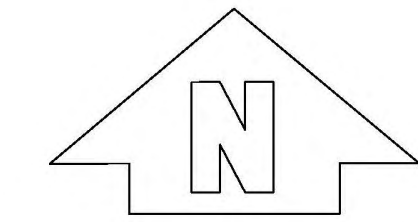
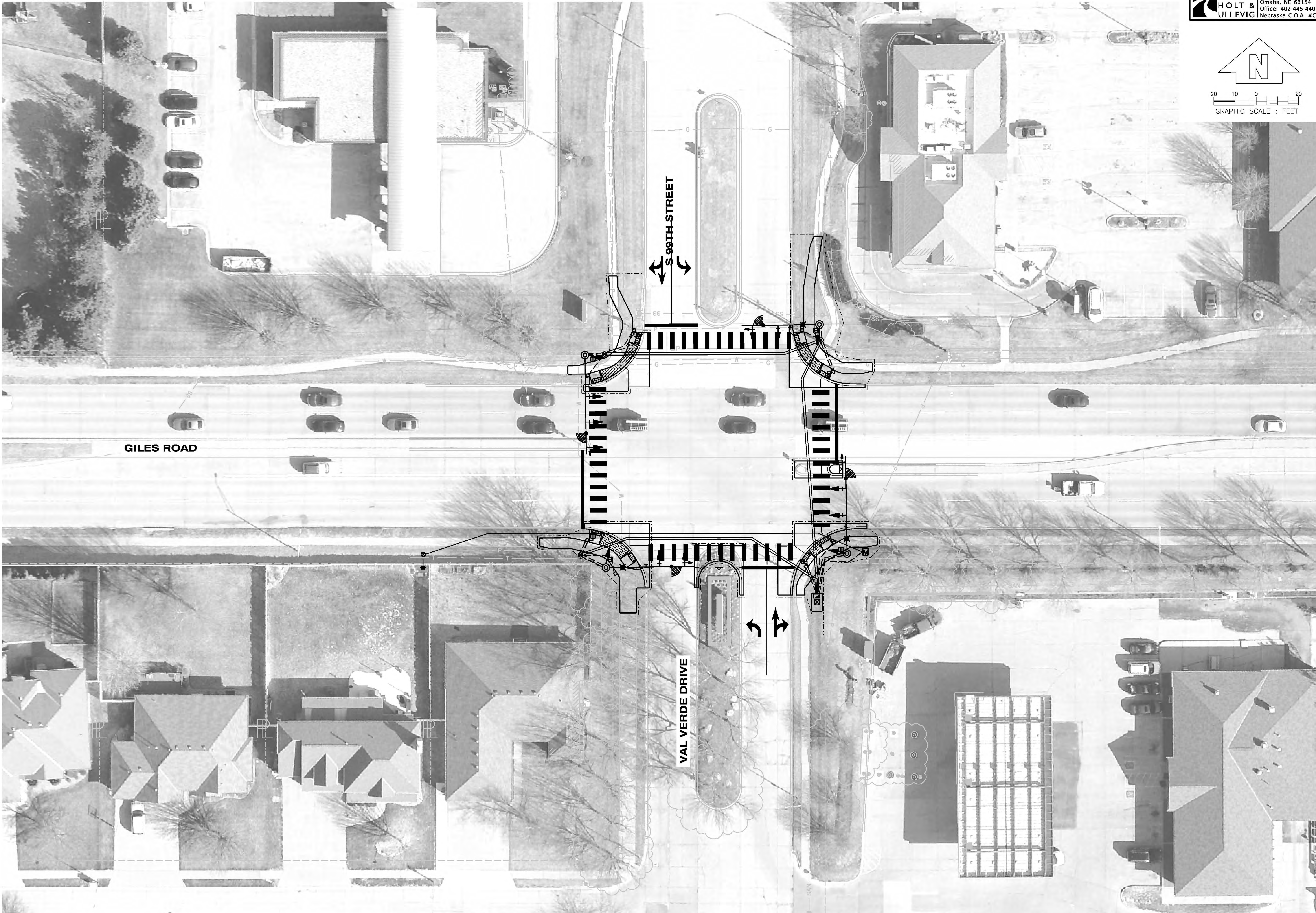

20 10 0 20
GRAPHIC SCALE : FEET

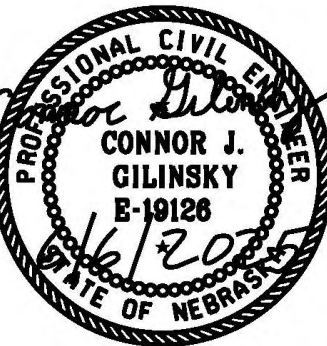

GILES ROAD

FELSBURG
HOLT &
ULLEVIG 14606 Branch St., Ste 400
Omaha, NE 68154
Office: 402-445-4405
Nebraska C.O.A. #CA-2681

4

Project Number
20241203

99TH & GILES ROAD
CURB RAMPS AND
SIGNAL DESIGN

REMOVE PAVEMENT			
LOCATION	SQ. YDS.	TYPE	*THICKNESS
NORTHWEST CORNER	36	CONCRETE	10"
SOUTHWEST CORNER	36	CONCRETE	10"
SOUTH MEDIAN	16	CONCRETE	10"
SOUTHEAST CORNER	48	CONCRETE	10"
NORTHEAST CORNER	32	CONCRETE	10"
EAST MEDIAN	10	CONCRETE	10"

* FIELD VERIFY

REMOVE MEDIAN SURFACING	
LOCATION	SQ. FT.
EAST MEDIAN	85

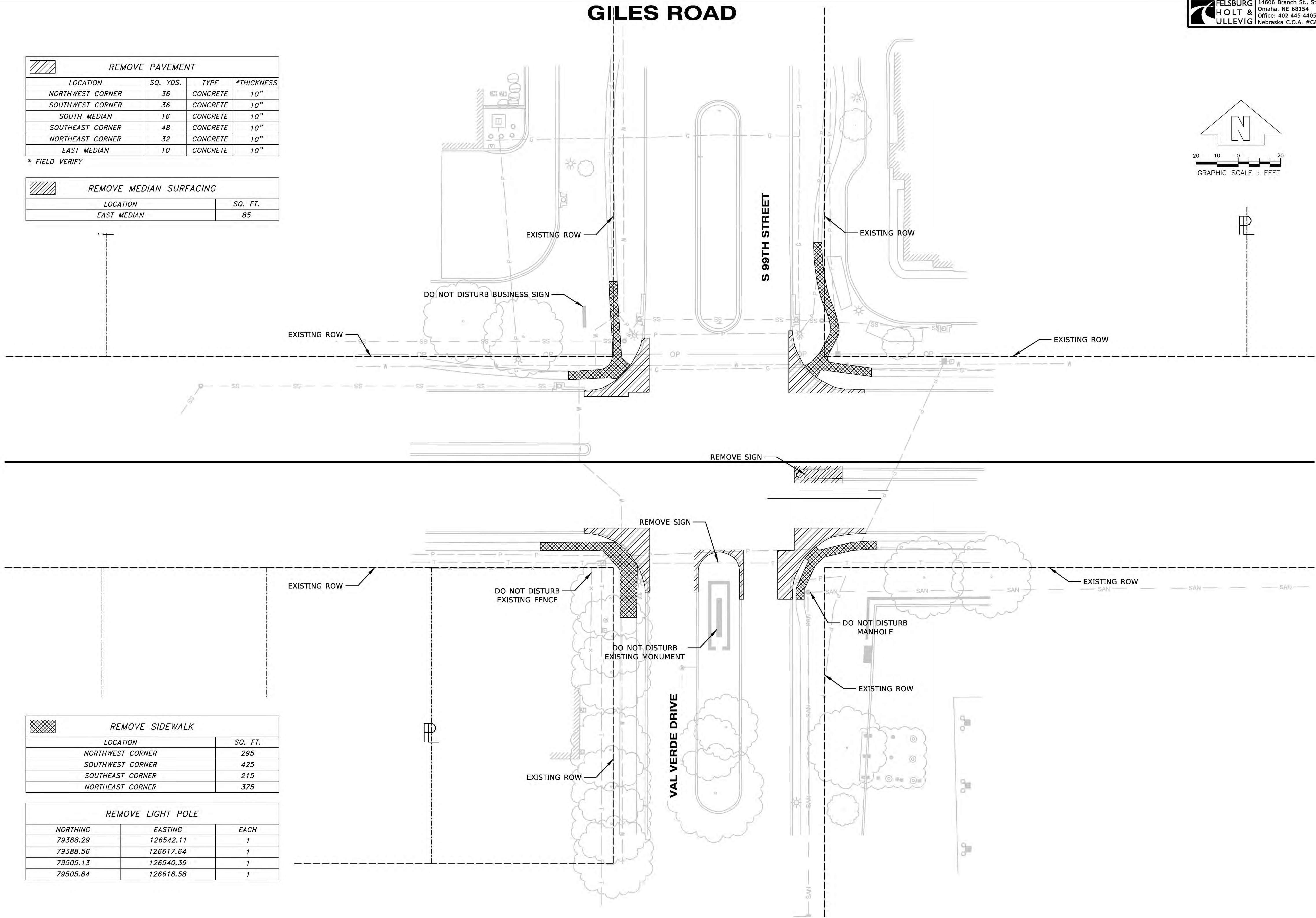
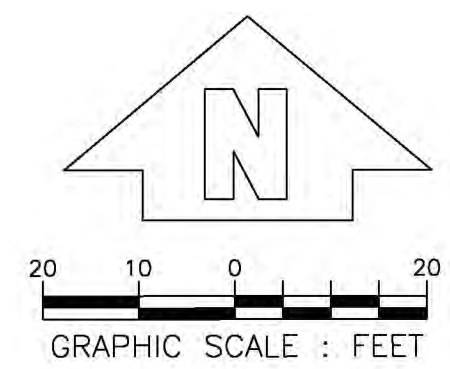

REMOVE SIDEWALK	
LOCATION	SQ. FT.
NORTHWEST CORNER	295
SOUTHWEST CORNER	425
SOUTHEAST CORNER	215
NORTHEAST CORNER	375

REMOVE LIGHT POLE		
NORTHING	EASTING	EACH
79388.29	126542.11	1
79388.56	126617.64	1
79505.13	126540.39	1
79505.84	126618.58	1

REMOVALS

FELSBURG
HOLT &
ULLEVIG

Roadway
Design
Division



COMPUTER: GX36

DATE: 6-JUN-2025 08:38

FILE: 124434 Sheets Removal.dgn

GILES ROAD

FELSBURG
HOLT &
ULLEVIG

14606 Branch St., Ste 400
Omaha, NE 68154
Office: 402-445-4405
Nebraska C.O.A. #CA-2681

5

Project Number

20241203

99TH & GILES ROAD
CURB RAMP AND
SIGNAL DESIGN

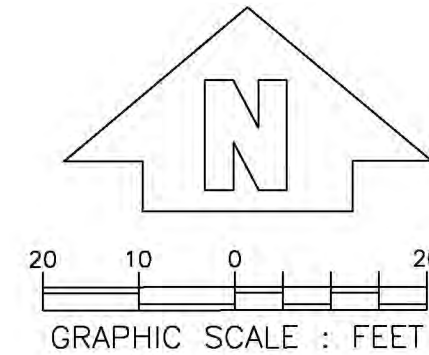

CONSTRUCT 10" CONCRETE PAVEMENT (OPW-3500)	
LOCATION	SQ. YDS.
NORTHWEST CORNER	36
SOUTHWEST CORNER	36
SOUTH MEDIAN	16
SOUTHEAST CORNER	48
NORTHEAST CORNER	32
EAST MEDIAN	20

CONSTRUCT 6" PCC SIDEWALK	
LOCATION	SQ. FT.
NORTHWEST CORNER	310
SOUTHWEST CORNER	215
SOUTHEAST CORNER	527
NORTHEAST CORNER	415

CONSTRUCT 6" IMPRINTED PCC SURFACE	
LOCATION	SQ. FT.
NORTHWEST CORNER	86
SOUTHWEST CORNER	76
SOUTHEAST CORNER	64
NORTHEAST CORNER	66

CONSTRUCT PCC CURB RAMP				
LOCATION	CROSSING DIRECTION	SQ. FT.	DETECTABLE WARNING PANEL SQ. FT.	
NORTHWEST CORNER	SOUTH	30	8	
NORTHWEST CORNER	EAST	28	8	
SOUTHWEST CORNER	NORTH	36	8	
SOUTHWEST CORNER	EAST	50	8	
SOUTHEAST CORNER	WEST	26	8	
SOUTHEAST CORNER	NORTH	30	8	
NORTHEAST CORNER	WEST	30	8	
NORTHEAST CORNER	SOUTH	30	8	

CONSTRUCT PCC MEDIAN SURFACING	
LOCATION	SQ. FT.
EAST MEDIAN	24

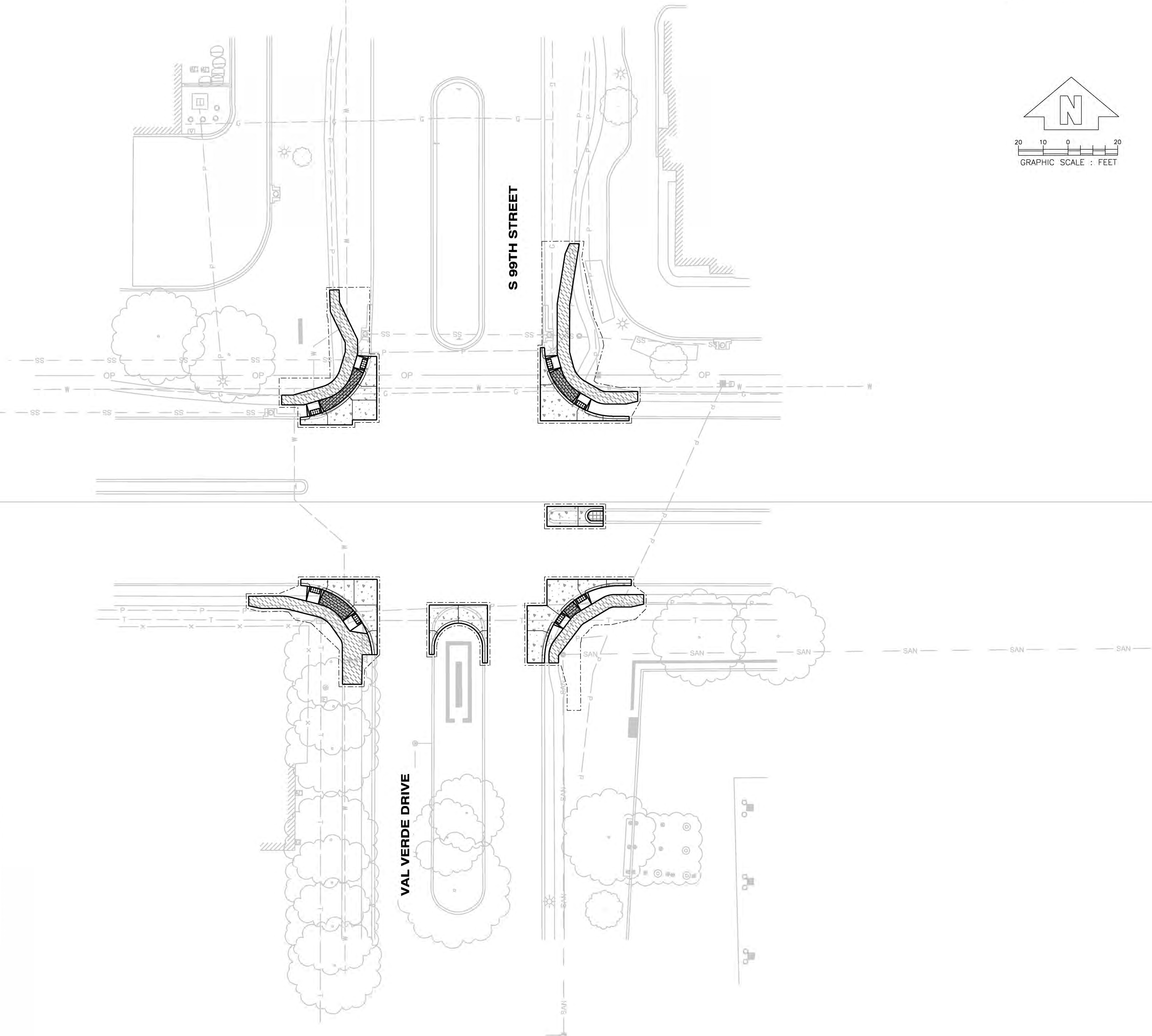

CONSTRUCTION



Roadway
Design
Division

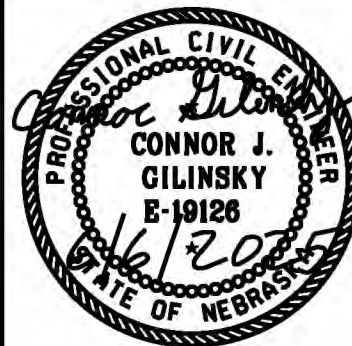

GILES ROAD

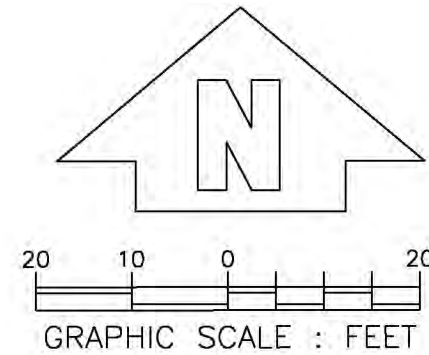

ROADWAY GEOMETRICS

1 30' R.P. N 79509.02 E 126514.57	13 2' R.P. N 79439.11 E 126634.39	25 9.75' R.P. N 79386.18 E 126580.14
2 N 79476.08 E 126516.57	14 N 79442.97 E 126638.64	26 N 79379.89 E 126589.87
3 N 79478.04 E 126537.55	15 N 79441.09 E 126638.63	27 N 79379.89 E 126591.87
4 N 79476.04 E 126537.54	16 N 79437.09 E 126638.62	28 N 79403.21 E 126591.93
5 N 79478.02 E 126547.37	17 N 79434.97 E 126638.62	29 N 79379.85 E 126607.93
6 N 79503.62 E 126547.43	18 N 79413.74 E 126516.68	30 N 79379.84 E 126614.87
7 N 79506.96 E 126613.44	19 30' R.P. N 79381.24 E 126515.38	31 N 79402.96 E 126607.93
8 N 79477.53 E 126613.38	20 N 79413.67 E 126547.45	32 N 79402.96 E 126615.93
9 30' R.P. N 79507.27 E 126643.16	21 N 79383.32 E 126547.38	33 N 79413.52 E 126615.95
10 N 79477.45 E 126649.15	22 N 79403.27 E 126568.43	34 30' R.P. N 79380.96 E 126644.88
11 N 79443.02 E 126616.01	23 N 79383.38 E 126568.38	35 N 79413.47 E 126649.95
12 N 79435.02 E 126615.99	24 N 79383.39 E 126570.38	36 N 79410.95 E 126649.94

CURB RAMP GEOMETRICS

1 N 79480.20 E 126522.90	5 N 79410.32 E 126522.75
2 N 79500.22 E 126543.25	6 N 79398.37 E 126540.01
3 N 79500.07 E 126616.10	7 N 79398.27 E 126620.38
4 N 79483.02 E 126629.17	8 N 79406.54 E 126629.20

SIDEWALK GEOMETRICS

1 N 79488.07 E 126509.11	15 N 79524.21 E 126625.29	29 N 79371.54 E 126533.37
2 N 79484.14 E 126509.10	16 N 79504.45 E 126620.25	30 N 79383.33 E 126541.35
3 N 79488.07 E 126513.65	17 N 79505.09 E 126625.25	31 N 79371.53 E 126541.12
4 N 79484.14 E 126518.07	18 10' / 15' R.P. N 79502.10 E 126636.40	32 N 79379.84 E 126616.66
5 10' / 15' R.P. N 79501.18 E 126523.01	19 5' / 10' R.P. N 79494.20 E 126640.08	33 N 79379.84 E 126620.50
6 N 79525.40 E 126528.65	20 N 79484.20 E 126647.98	34 10' R.P. N 79382.67 E 126626.65
7 N 79521.67 E 126528.78	21 N 79485.27 E 126652.66	35 5' / 10' R.P. N 79391.55 E 126633.43
8 N 79509.24 E 126534.75	22 N 79489.20 E 126652.70	36 5' / 10' R.P. N 79397.34 E 126643.27
9 N 79525.42 E 126532.52	23 N 79406.98 E 126495.61	37 N 79402.33 E 126649.88
10 N 79510.40 E 126539.75	24 N 79403.14 E 126495.62	38 N 79403.42 E 126654.89
11 N 79548.83 E 126625.32	25 N 79402.01 E 126500.64	39 N 79407.31 E 126654.89
12 N 79548.84 E 126629.23	26 15' / 20' R.P. N 79387.05 E 126508.19	40 N 79530.40 E 126528.48
13 N 79544.70 E 126623.51	27 10' / 15' R.P. N 79389.02 E 126520.78	41 N 79530.42 E 126532.35
14 N 79524.62 E 126620.29	28 5' R.P. N 79386.92 E 126528.34	

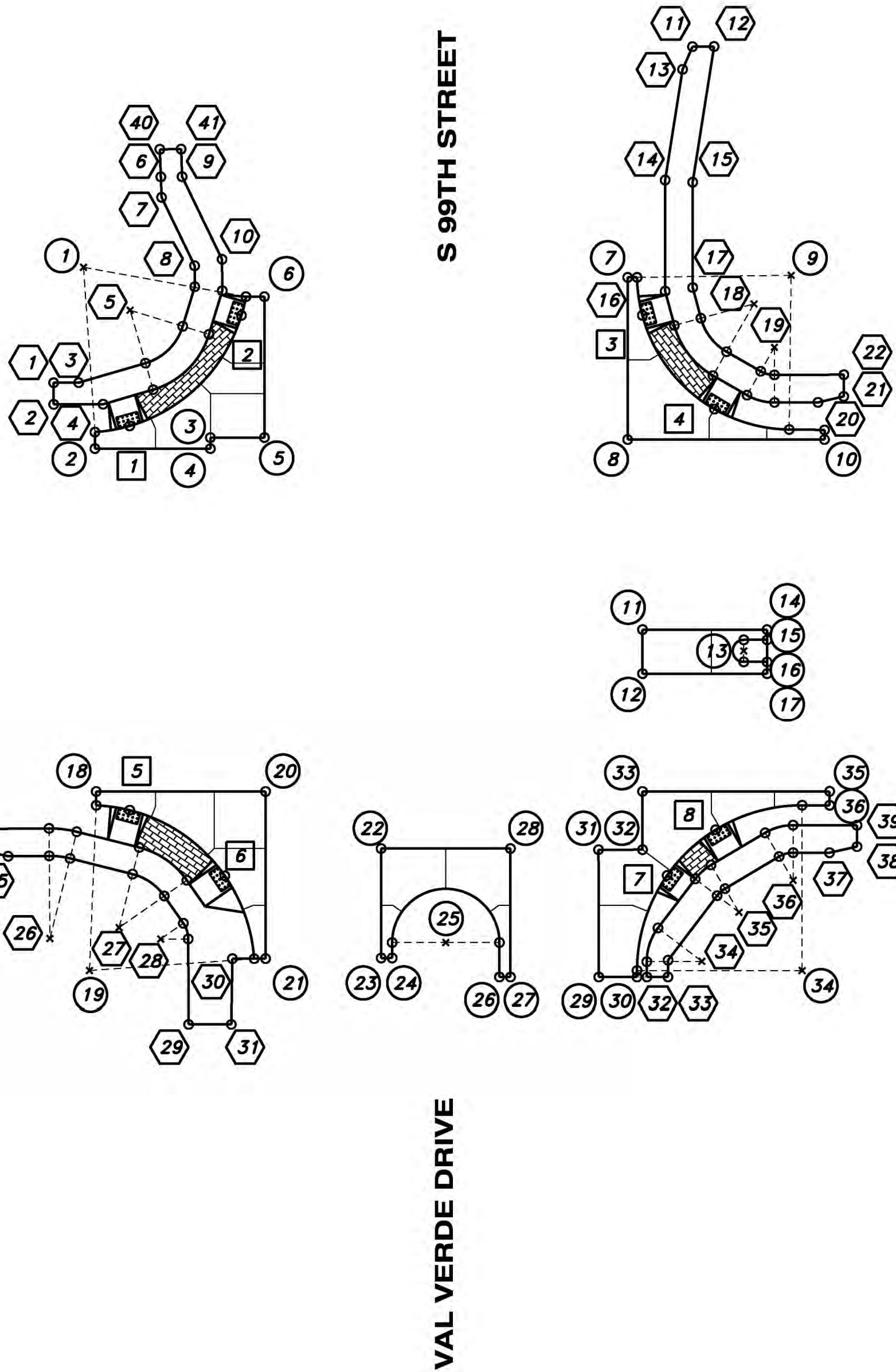

GENERAL NOTES - GEOMETRICS:

1. EDGE OF PAVEMENT COORDINATES ARE APPROXIMATE AND SHOULD BE ADJUSTED IN FIELD TO MATCH EXISTING JOINT LOCATIONS.

GEOMETRICS



Roadway
Design
Division



GILES ROAD

FELSBURG
HOLT &
ULLEVIG
14606 Branch St., Ste 400
Omaha, NE 68154
Office: 402-445-4405
Nebraska C.O.A. #CA-2681

7

Project Number

20241203

99TH & GILES ROAD
CURB RAMP AND
SIGNAL DESIGN

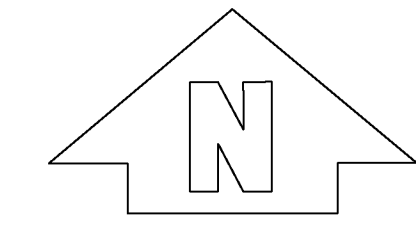

20 10 0 10 20
GRAPHIC SCALE : FEET

JOINTS & GRADES



Roadway
Design
Division

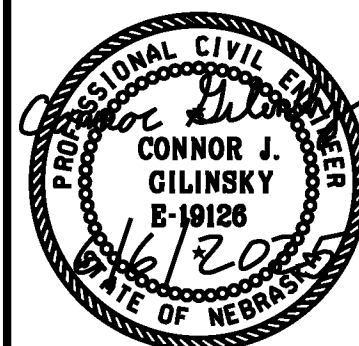

GENERAL NOTES – GRADES:

1. GRADES ARE APPROXIMATE AND SHOULD BE ADJUSTED TO FIT FIELD CONDITIONS.

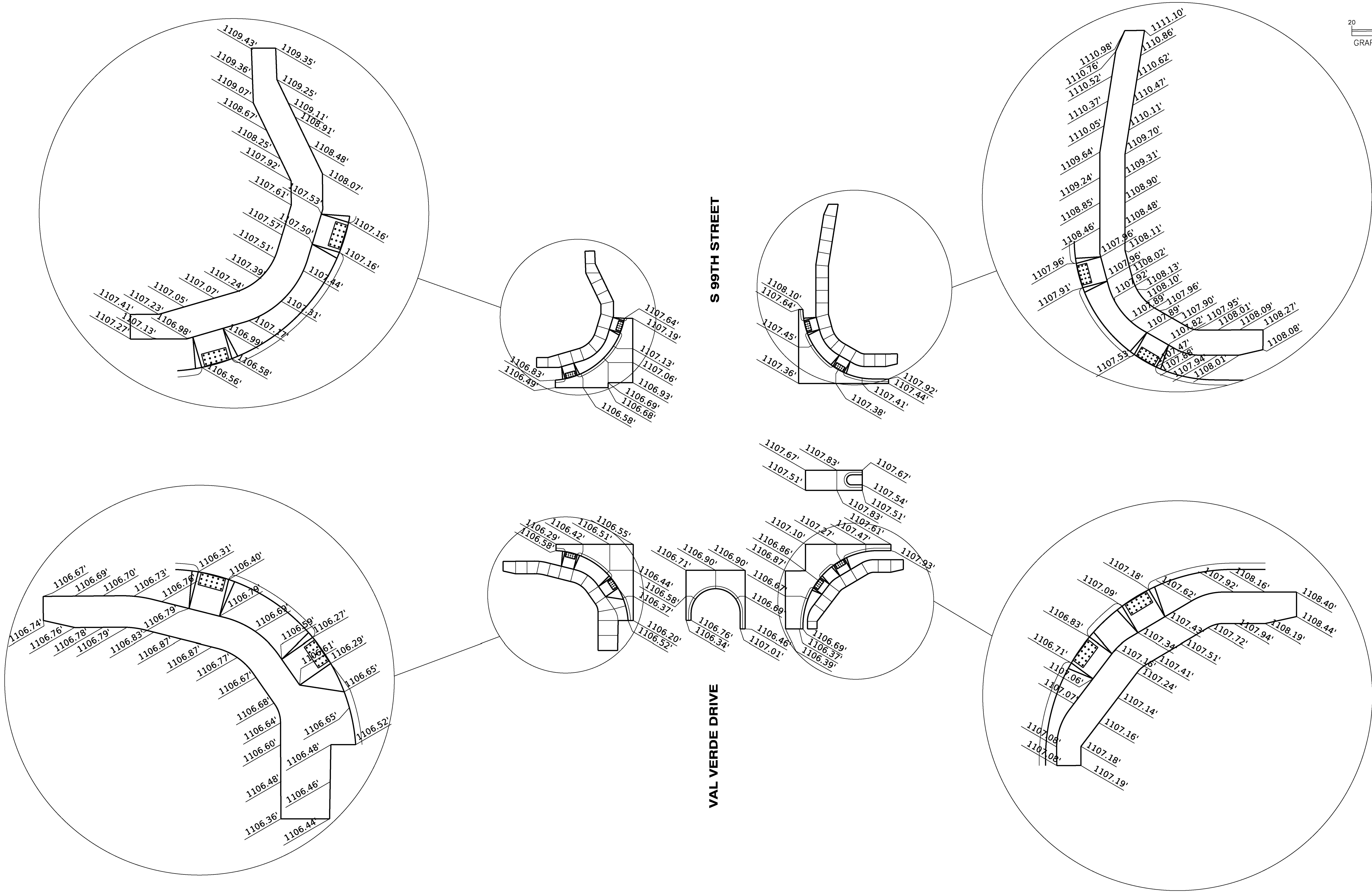

GILES ROAD

FELSBURG
HOLT &
ULLEVIG 14606 Branch St., Ste 400
Omaha, NE 68154
Office: 402-445-4405
Nebraska C.O.A. #CA-2681

8

Project Number
20241203

99TH & GILES ROAD
CURB RAMP AND
SIGNAL DESIGN

SUMMARY OF SIGNING AND STRIPING QUANTITIES		
QTY	UNIT	ITEM
100	LF	INSTALL PERMANENT PREFORMED TAPE MARKING - TYPE 4 GROOVED, 5" WHITE
125	LF	INSTALL PERMANENT PREFORMED TAPE MARKING - TYPE 4 GROOVED, 16" WHITE
400	LF	INSTALL PERMANENT PREFORMED TAPE MARKING - TYPE 4 GROOVED, 24" WHITE
2	EA	INSTALL PERMANENT PREFORMED TAPE SYMBOL - TYPE DIRECTIONAL ARROW, WHITE (LT)
2	EA	INSTALL PERMANENT PREFORMED TAPE SYMBOL - TYPE DIRECTIONAL ARROW, WHITE (ST/RT)
2	EA	FURNISH & INSTALL TRAFFIC POSTS AND SIGNS

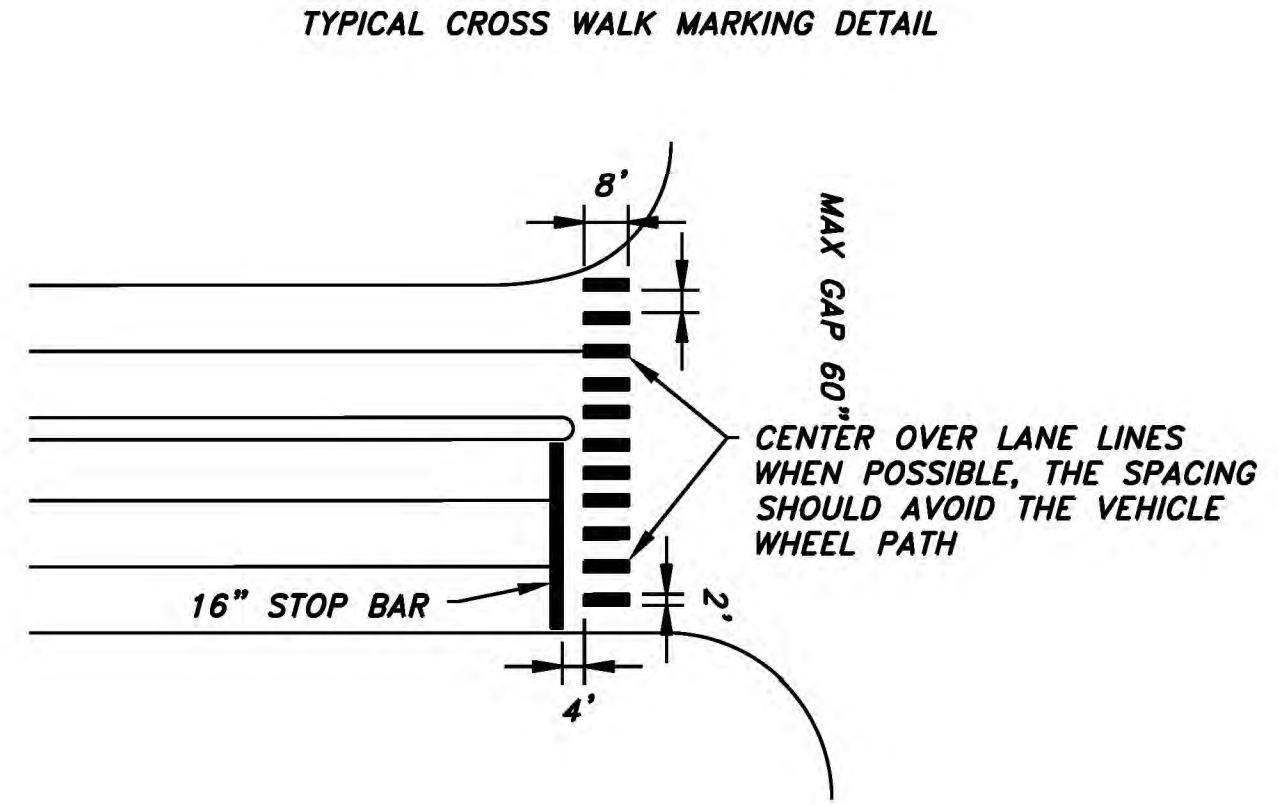
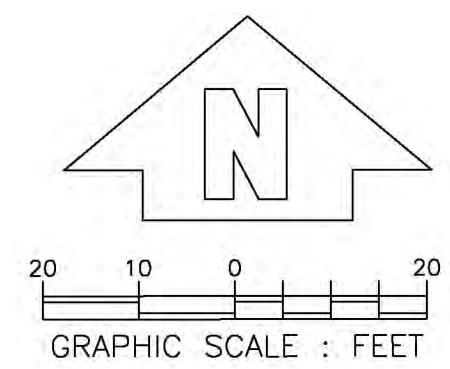
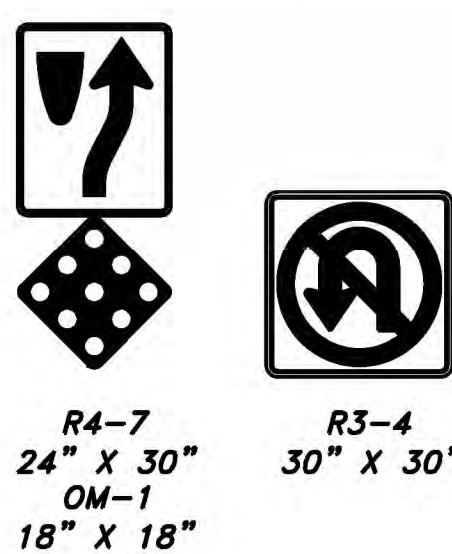

- GENERAL NOTES - STRIPING:
- ALL SIGNS IN ISLANDS SHALL BE INSTALLED USING BREAKAWAY ANCHORS PER PLANS AND SPECIFICATIONS.
 - SKIP LANE LINES SHALL HAVE A 10 FT. STRIPE WITH A 30 FT. GAP. ALL 5" WHITE SKIP LANE LINES SHALL BE CONTRAST WET REFLECTIVE PAINT MARKINGS.
 - SHORT SKIP LANE LINES SHALL HAVE A 2 FT. STRIPE WITH A 6 FT. GAP.
 - STOP BARS SHALL BE 16 IN. WIDE AND CROSSWALKS SHALL BE 24 IN. WIDE.
 - ALL SIGN LOCATIONS ARE APPROXIMATE AND MAY BE ADJUSTED TO FIT FIELD CONDITIONS. SIGNS MAY BE MOUNTED ON STREET LIGHT POLES.
 - ALL CONFLICTING PAVEMENT MARKINGS SHALL BE REMOVED AND CONSIDERED SUBSIDIARY TO THE PERMANENT STRIPING BID ITEM.
 - CONTRACTOR IS RESPONSIBLE TO PROVIDE AND INSTALL ALL SIGNS.
 - A 6" DIAMETER OPENING FOR SIGN POSTS LOCATED IN THE MEDIAN ISLAND/MEDIAN NOSE SHALL BE PROVIDED. THIS WORK SHALL BE CONSIDERED SUBSIDIARY TO THE MEDIAN ISLAND AND MEDIAN NOSE CONSTRUCTION. MEDIAN NOSE SHALL BE PAINTED YELLOW.

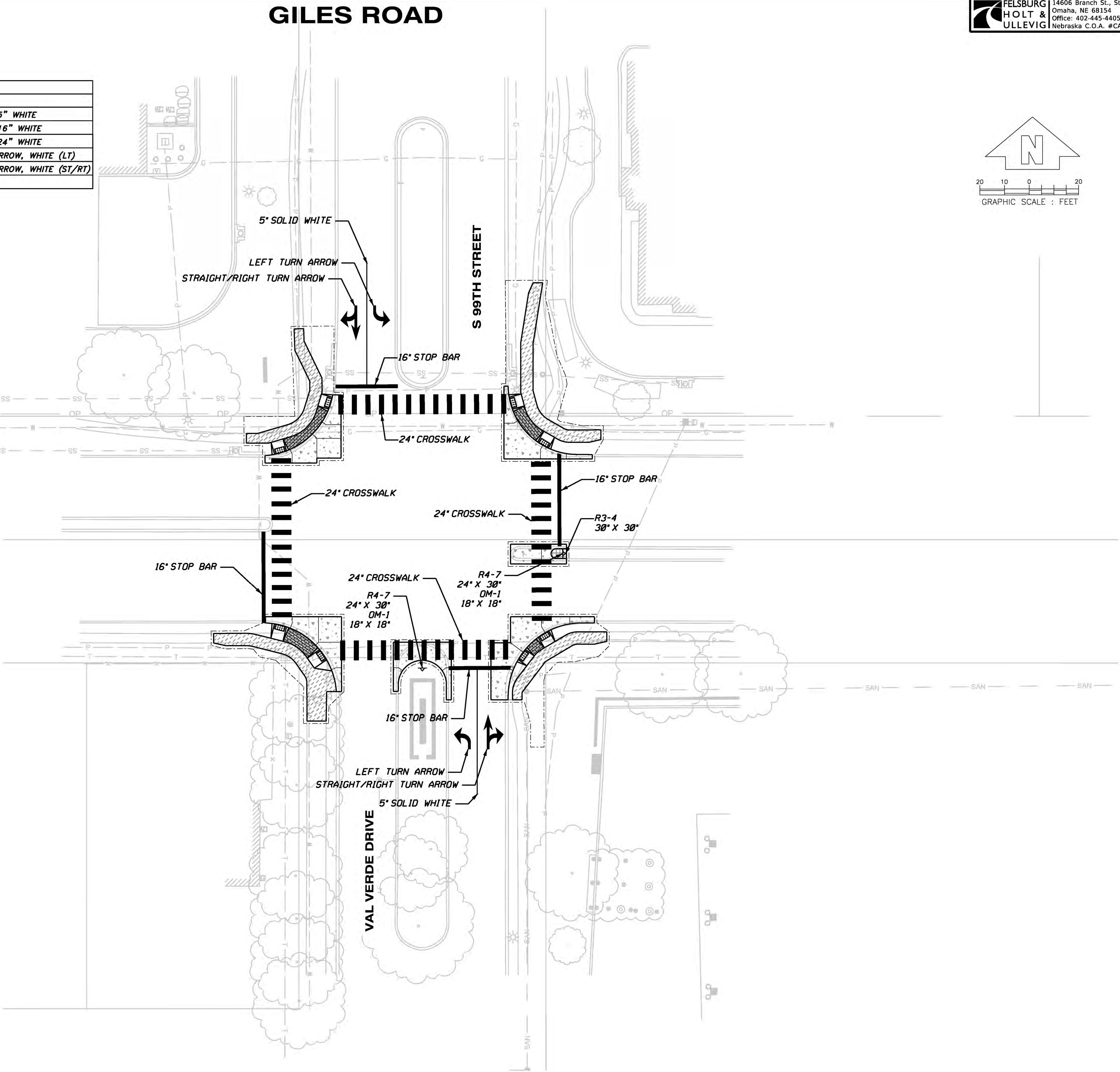

SIGNING & STRIPING

FELSBURG
HOLT &
ULLEVIG

Roadway
Design
Division



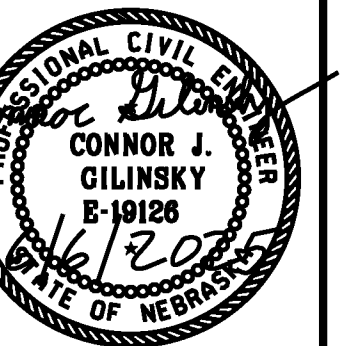

SIGNAL GENERAL NOTES

1. THE CITY OF OMAHA STANDARD SPECIFICATIONS FOR PUBLIC WORKS CONSTRUCTION, 2024 EDITION, AND ANY CURRENT REVISIONS OR AMENDMENTS THERETO, SHALL APPLY TO THIS CONSTRUCTION AND THE CONTRACTOR SHALL PERFORM IN ACCORDANCE THEREWITH.
2. THE CONTRACTOR IS RESPONSIBLE TO INSURE ALL EXCAVATIONS ARE MADE IN ACCORDANCE WITH THE OCCUPATIONAL SAFETY AND HEALTH ADMINISTRATION (OSHA) CONSTRUCTION STANDARDS - 29 CRF PART 1926, SUBPART P-EXCAVATIONS AS PUBLISHED IN THE FEDERAL REGISTER, VOL. 54, 209, TUESDAY, OCTOBER 31, 1989, RULES AND REGULATIONS.
3. THE CONTRACTOR SHALL COORDINATE CONSTRUCTION ACTIVITIES IN A MANNER THAT WILL PROVIDE PROTECTION OF EXISTING TREES AND BUSHES. THE TREES ON THE SOUTHWEST CORNER OF THE INTERSECTION SHALL BE TRIMMED IN A MANNER THAT THEY DO NOT OBSTRUCT THE VIEW OF THE TRAFFIC SIGNAL HEADS OR INTERFERE WITH THE CONSTRUCTION OF THE COMBINATION MAST ARM SIGNAL POLE.
4. UTILITIES ARE SHOWN AS A CONVENIENCE FOR THE CONTRACTOR. NEITHER THE ENGINEER NOR THE CITY GUARANTEE THE ACCURACY OF SUCH INFORMATION. LOCATIONS OF ALL AERIAL AND UNDERGROUND UTILITIES MAY NOT BE INDICATED ON THESE PLANS. UNDERGROUND UTILITIES, WHETHER INDICATED OR NOT, WILL BE LOCATED AND FLAGGED BY THE UTILITY COMPANIES AT THE CONTRACTOR'S REQUEST. NO EXCAVATION WILL BE PERMITTED IN THE AREA OF UNDERGROUND UTILITIES UNTIL ALL FACILITIES HAVE BEEN LOCATED AND IDENTIFIED TO THE SATISFACTION OF ALL PARTIES AND THEN ONLY WITH EXTREME CARE TO AVOID ANY DAMAGE TO THE UTILITIES. ANY UTILITY DAMAGED BY THE CONTRACTOR DUE TO HIS OPERATIONS SHALL BE REPAIRED BY THE CONTRACTOR AT THEIR EXPENSE.
5. THE CONTRACTOR SHALL FURNISH AND MAINTAIN ALL NECESSARY BARRICADES, WARNING SIGNS, LIGHTS AND FLAGGERS PER THE MUTCD AND THE OMAHA BARRICADING STANDARDS AND THE CONTRACTOR SHALL INSPECT AND VERIFY ALL APPROPRIATE BARRICADES AND SIGNS ARE PLACED ACCORDINGLY AND UPRIGHT AT THE END OF EACH CONSTRUCTION DAY, OR AS DIRECTED BY THE ENGINEER.
6. THE CONTRACTOR SHALL DISPOSE OF ALL UNSUITABLE MATERIALS ENCOUNTERED IN THE REMOVAL AND GRADING OPERATIONS OFF THE PROJECT SITE, INCLUDING CONCRETE, ASPHALT, OIL MAT, BRICK, ROCK, ETC. NO UNSUITABLE MATERIAL SHALL BE USED FOR BACKFILLING OF EMBANKMENT CONSTRUCTION. THE COST FOR DISPOSAL OF UNSUITABLE MATERIAL SHALL BE SUBSIDIARY TO THE PROJECT.
7. THE CONTRACTOR SHALL DISPOSE OF EXCESS MATERIAL AT AN OFF-SITE LOCATION. SUITABLE EXCESS MATERIAL MAY BE UTILIZED FOR FILL. NO PAYMENT WILL BE MADE FOR THE DISPOSAL OF EXCESS MATERIAL HAULED OFF SITE.
8. CONCRETE WASHOUT STATIONS SHALL BE CONSTRUCTED AS NEEDED DURING THE PAVING OPERATIONS. THIS SHALL BE CONSIDERED SUBSIDIARY TO OTHER ITEMS RECEIVING DIRECT PAYMENT.
9. THE CONTRACTOR SHALL BE RESPONSIBLE FOR CAPPING SPRINKLER SYSTEMS THAT ARE IMPACTED DURING THE PROJECT. THIS SHALL BE CONSIDERED SUBSIDIARY TO OTHER ITEMS RECEIVING DIRECT PAYMENT.
10. GENDER SPECIFIC SIGNS, SUCH AS FLAGMAN AND MEN WORKING, WILL NOT BE ALLOWED. THE SIGNS SHALL EITHER BE NEUTRAL GENDER, AS FLAGGER, OR EQUIVALENT SYMBOL SIGNS.
11. ALL OVERHEAD SIGNALS SHALL BE MOUNTED WITH MA-5 MOUNTINGS, HAVE BACKPLATES AND BE CENTERED OVER THEIR APPROACH LANES.
12. ALL SIDE MOUNTED SIGNALS SHALL BE MOUNTED WITH A B-4 ALTERNATE MOUNTING.
13. THE COST OF PUSH BUTTON SIGNS SHALL BE INCLUDED IN THE PAY ITEM "APS PEDESTRIAN PUSH BUTTON, TYPE PPB".
14. CABLE CHECKS SHOULD BE MADE PRIOR TO ORDERING MATERIALS TO VERIFY MAST ARM LENGTHS.
15. ALL SURFACE MATERIALS THAT ARE DISTURBED BY EXCAVATION AND BACKFILLING OPERATIONS SHALL BE REPLACED AND RESTORED IN KIND (INCLUDING THE SEEDING OF ANY DISTURBED AREAS) CONSIDERED INCIDENTAL TO OTHER PAY ITEMS.
16. CONTRACTOR TO SUPPLY AND INSTALL THE SERVICE ENTRANCE CABLE (3-SEC) FROM THE POWER SOURCE TO THE SERVICE DISCONNECT (PEDESTAL), THE SERVICE CABLE (2-SC) AND GROUNDING CONDUCTOR (1-GC) FROM THE SERVICE DISCONNECT (PEDESTAL) TO THE TRAFFIC SIGNAL CONTROLLER CABINET, AND THE STREET LIGHTING CABLE (1-3/C) FROM THE SERVICE DISCONNECT (PEDESTAL) TO THE TRANSFORMER BASE OF THE NEAREST SIGNAL POLE FOR STREET LIGHTING.
17. IF THE ELEVATION OF A FOUNDATION OF A SIGNAL POLE OR A PAD MOUNTED CONTROLLER CABINET DOES NOT MATCH THE SURROUNDING ELEVATION OF THE NEW SIDEWALK CONSTRUCTION OR BACK OF CURB ON THIS PROJECT, THEN THE CONTRACTOR SHALL RECONSTRUCT THE FOUNDATION AT THE PROPER ELEVATION AT NO ADDITIONAL COST TO THE PROJECT.
18. THE CONTRACTOR SHALL CONTACT THE CONSTRUCTION INSPECTOR WITH TWO WEEKS NOTICE IN ORDER TO ARRANGE TO HAVE A REPRESENTATIVE FROM THE CITY COME OUT TO FIELD LOCATE THE SERVICE DISCONNECT PEDESTAL. THE SERVICE DISCONNECT PEDESTAL SHALL BE INSTALLED AND CONNECTED TO THE POWER SOURCE AS SOON AS POSSIBLE AFTER CONSTRUCTION BEGINS ON THE SIGNAL.
19. BEFORE THE SCHEDULED TURN-ON FOR FINAL CONNECTIONS TO THE OVERHEAD LUMINAIRE HEADS, THE CONTRACTOR SHALL CONTACT BURT ADAMS (O.P.P.D.) AT 531-226-3333. THIS SHALL BE DONE BEFORE CONSTRUCTION BEGINS ON THIS PROJECT. THIS IS TO COORDINATE THE INSTALLATION OF THE UNDERGROUND WIRING FOR THE OVERHEAD LUMINAIRE HEADS.
21. THE CONTRACTOR AND CITY INSPECTOR SHALL ENSURE TO PROVIDE AT LEAST A 4 FOOT WIDE SIDEWALK PATH BETWEEN THE NEAREST SIDEWALK AND/OR WHEEL CHAIR RAMP FACILITY (IF PRESENT) AND EACH PEDESTRIAN PUSH BUTTON.
22. THE INITIAL LOCATION OF TRAFFIC SIGNAL FACILITIES SHALL BE PERFORMED BY THE ENGINEER AND/OR THE CITY OF LA VISTA. AFTER THE INITIAL LOCATE, THE CONTRACTOR SHALL BE RESPONSIBLE FOR LOCATING ALL AERIAL AND UNDERGROUND TRAFFIC SIGNAL FACILITIES AT EACH SIGNALIZED LOCATION UPON THE REQUEST OF PROTECTION PER NEBRASKA ONE-CALL STATUTES, WHETHER THE FACILITIES ARE AFFECTED BY THE PROJECT OR NOT. FOR EACH SIGNALIZED LOCATION, THESE LOCATING RESPONSIBILITIES WILL BEGIN AT THE COMMENCEMENT OF THE PROJECT AND WILL END UPON THE COMPLETION OF A SUCCESSFUL PERMANENT TRAFFIC SIGNAL TURN-ON.
23. * - INDICATES MATERIAL INCLUDED IN THE BID ITEM "FURNISH & INSTALL RADAR VEHICLE DETECTION SYSTEM-# APPROACH".

SIGNAL LEGEND

- | | |
|--|------------------------------------------------------------------|
| | TRAFFIC SIGNAL POLE, FOOTING SYMBOL, AND IDENTIFYING NUMBER |
| | POWER SOURCE |
| | TRAFFIC SIGNAL HEAD WITH BACKPLATE SYMBOL AND IDENTIFYING NUMBER |
| | TRAFFIC SIGNAL HEAD SYMBOL AND IDENTIFYING NUMBER |
| | PEDESTRIAN SIGNAL SYMBOL AND IDENTIFYING NUMBER |
| | LUMINAIRE ARM - 12 FEET |
| | TRAFFIC SIGNAL CONTROLLER AND CABINET |
| | ELECTRICAL METER |
| | MAST ARM MOUNTED SIGN AND IDENTIFYING NUMBER |
| | POLE MOUNTED SIGN AND IDENTIFYING NUMBER |
| | TRENCHED SIGNAL CONDUIT |
| | BORED CONDUIT |
| | PULL BOX, TYPE PB-8 & PB-10 |
| | PULL BOX, TYPE PB-6 |
| | RADAR VEHICLE DETECTOR |

GILES ROAD

FELSBURG
HOLT &
ULLEVIG
14606 Branch St., Ste 400
Omaha, NE 68154
Office: 402-445-4405
Nebraska C.O.A. #CA-2681

10

Project Number

20241203

99TH & GILES ROAD
CURB RAMPS AND
SIGNAL DESIGN

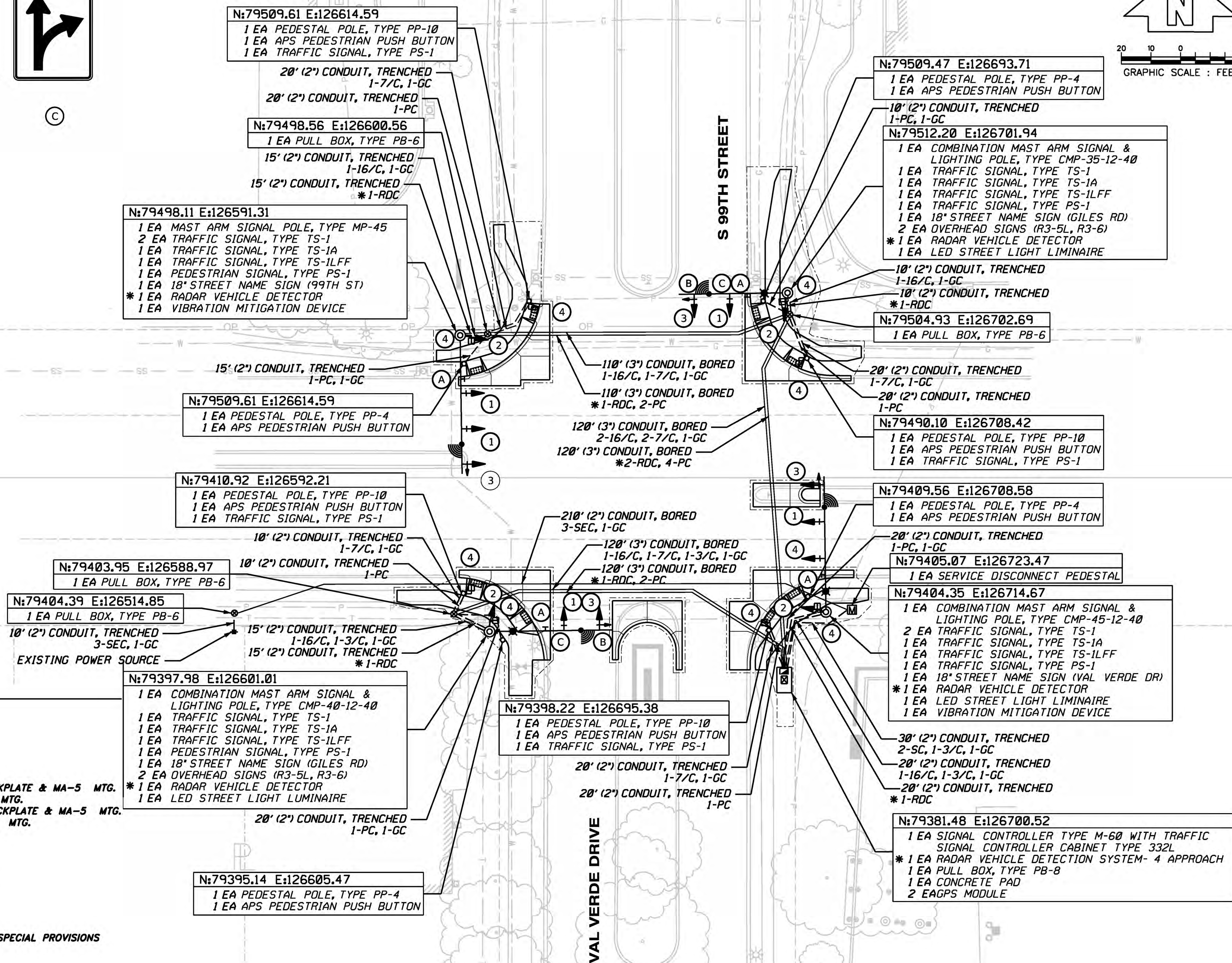
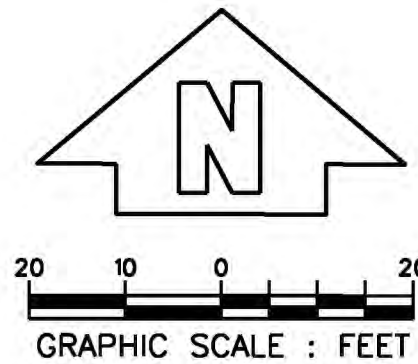

INTERSECTION NOTES

- TWO (2) GPS MODULES WILL BE NEEDED FOR THIS PROJECT. THEY WILL BE INSTALLED AT THE INTERSECTIONS OF GILES ROAD WITH 99TH STREET/VAL VERDE DRIVE AND AT 96TH STREET.
- ALL STREET NAME SIGNS SHALL HAVE THE CITY OF LA VISTA LOGO PLACED ON THE LEFT SIDE.

SHEET QUANTITIES

QNTY	UNIT	ITEM	REMARKS
1	EA	FURNISH & INSTALL MAST ARMS SIGNAL POLE, TYPE MP-45	
1	EA	FURNISH & INSTALL COMBINATION MAST ARM SIGNAL AND LIGHTING POLE, TYPE CMP-35-12-40	MTG. HT. 40'
1	EA	FURNISH & INSTALL COMBINATION MAST ARM SIGNAL AND LIGHTING POLE, TYPE CMP-40-12-40	MTG. HT. 40'
1	EA	FURNISH & INSTALL COMBINATION MAST ARM SIGNAL AND LIGHTING POLE, TYPE CMP-45-12-40	MTG. HT. 40'
6	EA	FURNISH & INSTALL TRAFFIC SIGNAL, TYPE TS-1	W/T31 FACE, VISORS, BACKPLATE & MA-5 MTG.
4	EA	FURNISH & INSTALL TRAFFIC SIGNAL, TYPE TS-1A	W/T31 FACE & B-4 ALT MTG.
4	EA	FURNISH & INSTALL TRAFFIC SIGNAL, TYPE TS-1LFF	W/T43F FACE, VISORS, BACKPLATE & MA-5 MTG.
8	EA	FURNISH & INSTALL PEDESTRIAN SIGNAL, TYPE PS-1	W/T-24 FACE & B-4 ALT MTG.
8	EA	FURNISH & INSTALL APS PEDESTRIAN PUSH BUTTON	SEE SPECIAL PROVISIONS
4	EA	FURNISH & INSTALL PEDESTAL POLE, TYPE PP-4	
4	EA	FURNISH & INSTALL PEDESTAL POLE, TYPE PP-10	
1	EA	INSTALL TRAFFIC SIGNAL CONTROLLER, TYPE M-60 WITH TRAFFIC SIGNAL CABINET 332L	SEE SPECIAL PROVISIONS
2	EA	FURNISH & INSTALL GPS MODULE	SEE SPECIAL PROVISIONS
2	EA	FURNISH & INSTALL VIBRATION MITIGATION DEVICE	
4	EA	FURNISH & INSTALL PULL BOX, TYPE PB-6	
1	EA	FURNISH & INSTALL PULL BOX, TYPE PB-8	
3	EA	INSTALL LED STREET LIGHT LUMINAIRE	OPPD TO PROVIDE - SEE SPECIAL PROVISIONS
365	LF	FURNISH & INSTALL 2" PVC CONDUIT, TRENCHED	
910	LF	FURNISH & INSTALL 3" PVC CONDUIT, BORED	
530	LF	FURNISH & INSTALL 16/C No. 14 AWG TRAFFIC SIGNAL CABLE	IMSA 20-1
540	LF	FURNISH & INSTALL 7/C No. 14 AWG TRAFFIC SIGNAL CABLE	IMSA 20-1
305	LF	FURNISH & INSTALL 3/C No. 6 AWG STREET LIGHTING CABLE	
1075	LF	FURNISH & INSTALL 2/C No. 16 PEDESTRIAN PUSH BUTTON LEAD-IN CABLE	IMSA 20-1
795	LF	FURNISH & INSTALL GROUNDING CONDUCTOR	1/C #8 BARE COPPER
60	LF	FURNISH & INSTALL SERVICE CABLE	
660	LF	FURNISH & INSTALL SERVICE ENTRANCE CABLE	
1	EA	FURNISH & INSTALL SERVICE DISCONNECT PEDESTAL	
1	EA	INSTALL CONCRETE PAD	
4	EA	FURNISH & INSTALL 18" STREET NAME SIGN	
4	EA	FURNISH & INSTALL OVERHEAD SIGNS	
1	EA	FURNISH & INSTALL RADAR VEHICLE DETECTION SYSTEM - 4 APPROACH	SEE SPECIAL PROVISIONS

99TH AND GILES ROAD SIGNAL
TRAFFIC SIGNAL

FELSBURG
HOLT &
ULLEVIG

Roadway
Design
Division

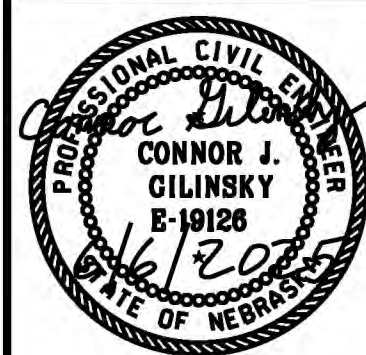

COMPUTER: GX36

DATE: 6-JUN-2025 08:39

FILE: 124434 Sheets Signal.dgn

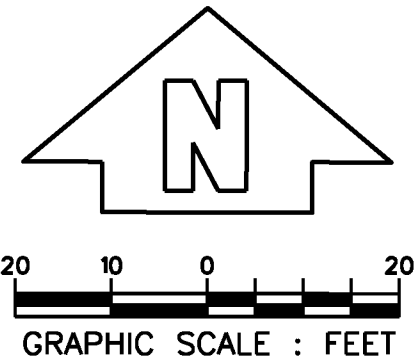

TRAFFIC SIGNAL PHASING

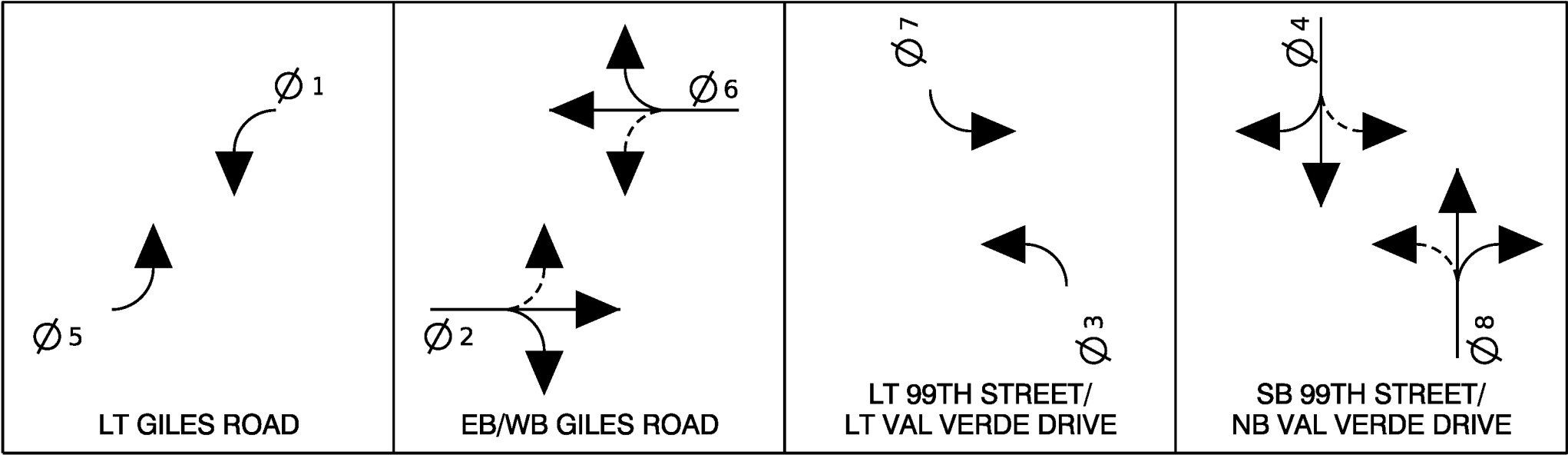

DETECTION LEGEND

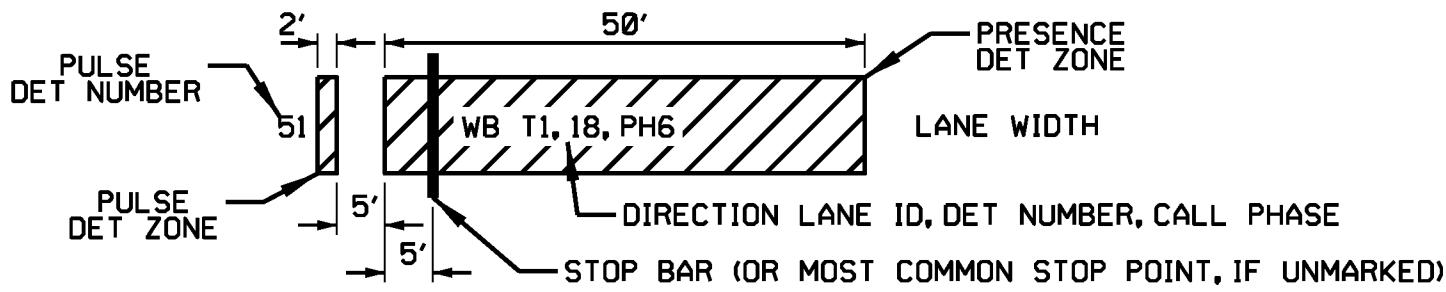

GILES ROAD

S 99TH STREET

VAL VERDE DRIVE

INTERSECTION NOTES

1. OVERLAP 1, TYPE FYA. INCLUDE PHASE 2, MODIFIED BY PHASE 1.
2. OVERLAP 3, TYPE FYA. INCLUDE PHASE 4, MODIFIED BY PHASE 3.
3. OVERLAP 5, TYPE FYA. INCLUDE PHASE 6, MODIFIED BY PHASE 5.
4. OVERLAP 7, TYPE FYA. INCLUDE PHASE 8, MODIFIED BY PHASE 7.

LEGEND

*** OUTPUT CHANNEL

NO SPLICES

WHERE NEW WIRE IS USED ON A SIGNAL PROJECT, SPLICES SHALL NOT BE ALLOWED. IF A SPLICE IS TO BE MADE THE CONTRACTOR SHALL NOTIFY THE ENGINEER BEFORE THE SPLICE IS MADE TO DETERMINE IF THE WIRE CAN BE INSTALLED WITHOUT SPLICING. ALL WIRING OF TRAFFIC SIGNAL CABLES SHALL BE IN ACCORDANCE WITH STANDARD PLATE 904-02. THE ONLY EXCEPTION IS ANY OVERHEAD-MOUNTED SIGNAL HEAD (REGARDLESS OF THE NUMBER OF SECTIONS) INSTALLED OVER AND FACING A LEFT TURN LANE SHALL HAVE A SEVEN (7) CONDUCTOR CABLE INSTALLED FROM THE HEAD ASSEMBLY TO THE SIGNAL POLE BASE, WITH AN EXTRA FOUR (4) FEET OF CABLE COILED IN THE SIGNAL BASE. PROVIDE AND INSTALL CONDUCTORS IN THE COMBINATION MAST ARM POLE AND IN THE LUMINAIRE ARM, AND CONNECT THE LUMINAIRE HEAD. CONNECT THE CONDUCTORS IN THE POLE SHAFT TO THE 3/C STREET LIGHTING CABLE AS INDICATED IN THE CONTRACT DOCUMENTS. TERMINATE THE 3/C AT THE SERVICE DISCONNECT PEDESTAL. ALL SPLICES SHALL MEET THE SPECIFICATION FOR GENREAL CONSTRUCTION REQUIREMENTS IN SECTION 904.03 OF THE CITY OF OMAHA STANDARD SPECIFICATIONS.

TRAFFIC SIGNAL DETECTOR LAYOUT AND PHASING



Roadway
Design
Division

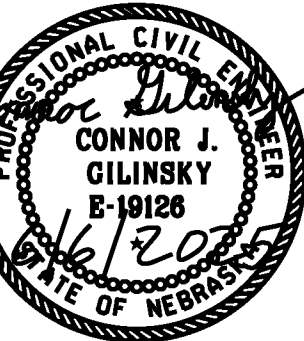

GILES ROAD

FELSBURG
HOLT &
ULLEVIG 14606 Branch St., Ste 400
Omaha, NE 68154
Office: 402-445-4405
Nebraska C.O.A. #CA-2681

12

Project Number
20241203

99TH & GILES ROAD
CURB RAMPS AND
SIGNAL DESIGN

LEGEND

- LIMITS OF CONSTRUCTION
- TYPE II EROSION CONTROL W/ SEEDING TYPE A
- WETLANDS - DO NOT DISTURB

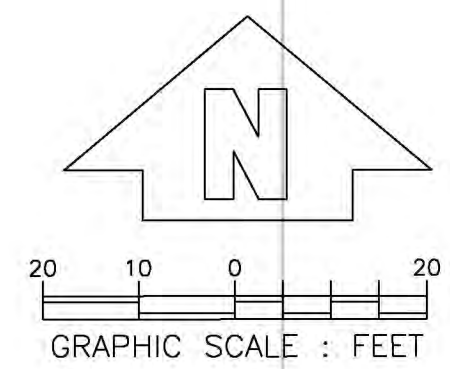

INSTALL ROLLED EROSION CONTROL, TYPE II WITH SEEDING - TYPE A		
LOCATION	SO. YD.	
NORTHWEST CORNER	55	
SOUTHWEST CORNER	25	
SOUTHEAST CORNER	280	
NORTHEAST CORNER	50	

INSTALL CURB INLET PROTECTION		
ID	LOCATION	EA.
CIP-101	NORTHWEST CORNER	1
CIP-102	NORTHWEST CORNER	1
CIP-103	NORTHEAST CORNER	1

*INLET LUGOUT FILTERS INCIDENTAL TO INLET PROTECTION

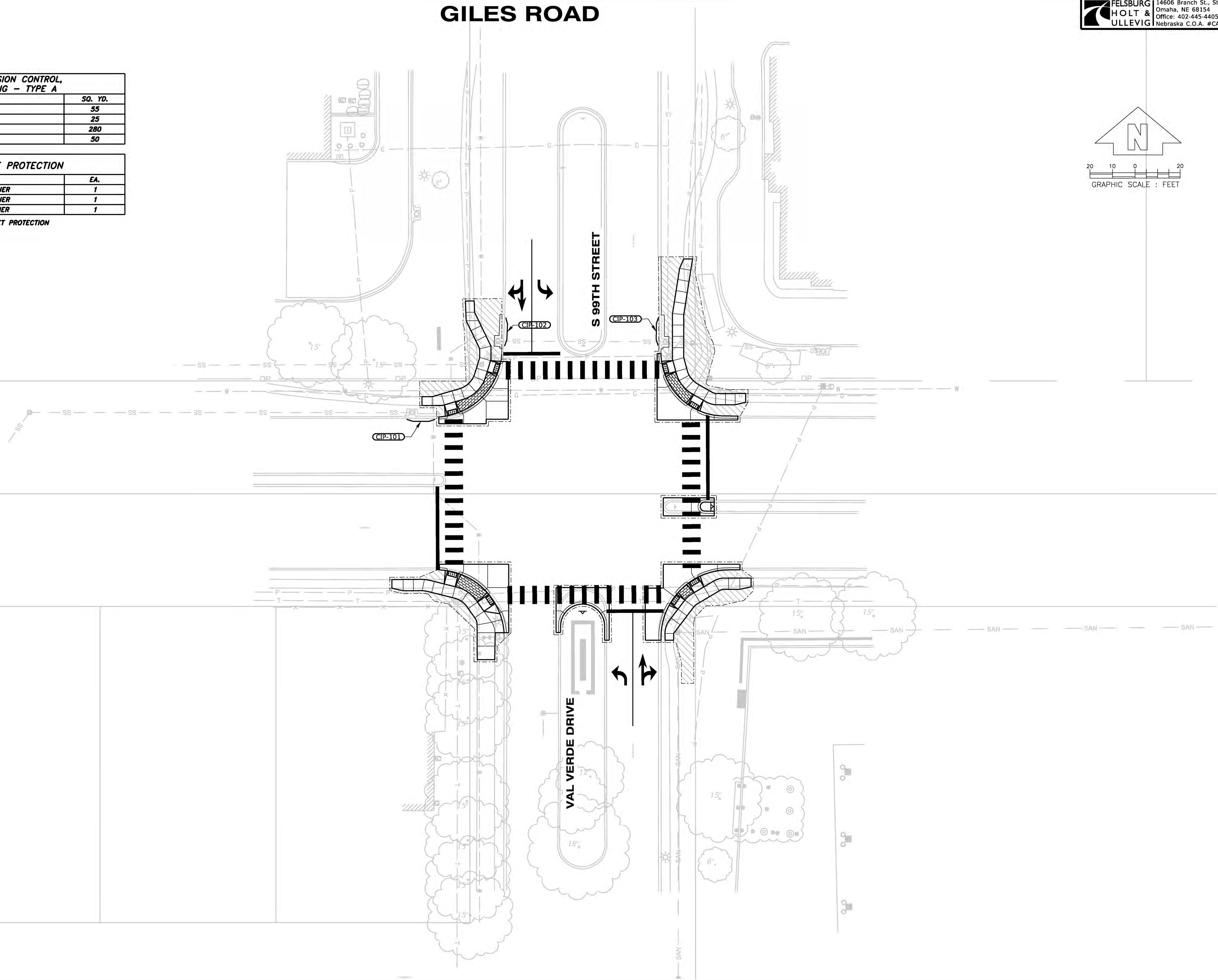

EROSION & SEDIMENT CONTROL

FELSBURG
HOLT &
ULLEVIG

Roadway
Design
Division

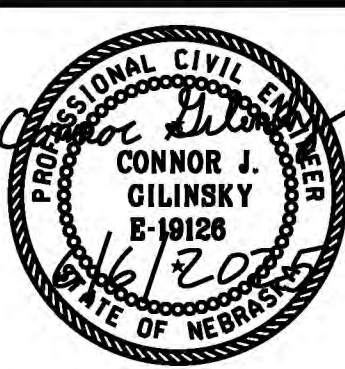

TRACT	OWNER	ADDRESS	LEGAL DESCRIPTION	ACQUISITION (SQ. FT.)	PERM. EASEMENT (SQ. FT.)	TEMP. EASEMENT (SQ FT.)	RIGHT OF ENTRY
1	CENTRIS FEDERAL CREDIT UNION	13120 PIERCE STREET, OMAHA, NE 68144	MAYFAIR 2ND ADDITION, LOT 118	175			
2	GILES INVESTORS LLC	9806 SEWARD STREET, OMAHA, NE 68114	MAYFAIR 2ND ADDITION REPLAT ONE, LOT 1			375	
3	CAMILLE CANTU	10206 CASPIAN DRIVE, PAPILLION NE 68046	VAL VERDE, LOT 36	50			
4	GIRI LLC	9901 S 100TH STREET, LA VISTA, NE 68128	VAL VERDE, LOT 250				

LEGEND

////

NEW
RIGHT-OF-WAY

||||

PERMANENT
EASEMENT

+

TEMPORARY
EASEMENT

RIGHT-OF-WAY

GILES ROAD

FELSBURG
HOLT &
ULLEVIG

14606 Branch St., Ste 400
Omaha, NE 68154
Office: 402-445-4405
Nebraska C.O.A. #CA-2681

14

Project Number
20241203

99TH & GILES ROAD
CURB RAMP AND
SIGNAL DESIGN

LEGEND

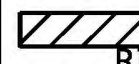
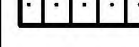
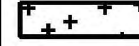
-  NEW
RIGHT-OF-WAY
-  PERMANENT
EASEMENT
-  TEMPORARY
EASEMENT

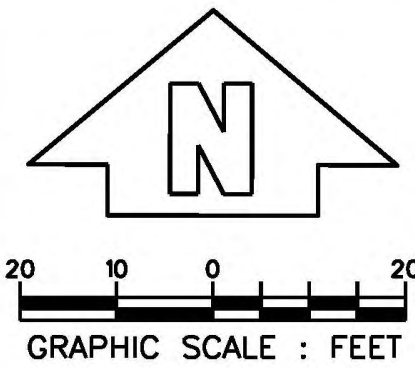

MAYFAIR 2ND ADDITION

MAYFAIR 2ND ADDITION
REPLPAT 1

LOT 118

LOT 1

LOT 36

LOT 250

VAL VERDE

VAL VERDE

RIGHT OF WAY OWNERSHIP

TRACT NO.	OWNER	OWNER ADDRESS	SITE ADDRESS	R.O.W. ACQUISITION (SQ.FT.)	PERM. EASEMENT (SQ.FT.)	TEMP. EASEMENT (SQ.FT.)
①	CENTRIS FEDERAL CREDIT UNION	13120 PIERCE STREET OMAHA, NE 68144	8250 S 99TH STREET LA VISTA, NE 68128	175	-	-
②	GILES INVESTORS LLC	9806 SEWARD STREET OMAHA, NE 68114	9848 GILES ROAD LA VISTA, NE 68128	-	-	375
③	CAMILLE CANTU	10206 CASPIAN DRIVE PAPILLION, NE 68046	9902 S 100TH STREET LA VISTA, NE 68128	50	-	-
④	GIRI LLC	9901 S 100TH STREET LA VISTA, NE 68128	9849 GILES ROAD LA VISTA, NE 68128	-	-	-

RIGHT-OF-WAY

FELSBURG
HOLT &
ULLEVIG

Roadway
Design
Division

