

**CITY OF LA VISTA
MAYOR AND CITY COUNCIL REPORT
MAY 4, 2010 AGENDA**

Subject:	Type:	Submitted By:
PARKVIEW HTS ELEMENTARY SCHOOL SAFE ROUTE TO SCHOOL PLAN	◆ RESOLUTION ORDINANCE RECEIVE/FILE	JOE SOUCIE PUBLIC WORKS DIRECTOR

SYNOPSIS

A resolution has been prepared modifying the extent of "School Speed Zones" and "No Parking Zones" according to the Parkview Heights Elementary School Safe Route to School Plan, as designed by the City Engineer and authorizing the Public Works Department to install appropriate signs.

FISCAL IMPACT

The FY10 budget includes funding for said signage.

RECOMMENDATION

Approval

BACKGROUND

The Parkview Heights Elementary School Safe Route to School Plan has been reviewed by the Public Works Department and has been coordinated with the Police Department and the Principal of Parkview Heights Elementary School. The following is a recommendation for the modified No Parking Zones and School Speed Zones:

1. A 15 MPH School Speed Zone on Granville Parkway from 400 feet west of the centerline of 87th Street to 180 feet west of the centerline of Elm Drive.
2. A 15 MPH School Speed Zone on Elm Drive from 140 feet north of the centerline of Granville Parkway to 170 feet south of the centerline of Granville Parkway.
3. A 15 MPH School Speed Zone on Honey Locust Drive from 240 feet east of the centerline of Elm Drive to 450 feet west of the centerline of Chinawood Avenue.
4. A No Parking Zone on the north side of Granville Parkway from the centerline of 89th Street to the centerline of Elm Drive.

RESOLUTION NO. _____

A RESOLUTION OF THE MAYOR AND CITY COUNCIL OF THE CITY OF LA VISTA, NEBRASKA MODIFYING THE EXTENT OF SCHOOL SPEED ZONES AND NO PARKING ZONES IN ACCORDANCE WITH THE PARKVIEW HEIGHTS ELEMENTARY SCHOOL SAFE ROUTE TO SCHOOL PLAN.

WHEREAS, the City Engineer has modified the Parkview Heights Route to School Plan; and

WHEREAS, City staff has reviewed the plan and recommends approval.

NOW, THEREFORE, BE IT RESOLVED, that the School Speed Zones near the Portal Elementary School are modified as follows:

1. A 15 MPH School Speed Zone on Granville Parkway from 400 feet west of the centerline of 87th Street to 180 feet west of the centerline of Elm Drive.
2. A 15 MPH School Speed Zone on Elm Drive from 140 feet north of the centerline of Granville Parkway to 170 feet south of the centerline of Granville Parkway.
3. A 15 MPH School Speed Zone on Honey Locust Drive from 240 feet east of the centerline of Elm Drive to 450 feet west of the centerline of Chinawood Avenue.

BE IT FURTHER RESOLVED, that the No Parking Zones near the Portal Elementary School are modified as follows:

1. A No Parking Zone on the north side of Granville Parkway from the centerline of 89th Street to the centerline of Elm Drive.

BE IF FURTHER RESOLVED, that the Public Works Department be, and hereby is, authorized to install the appropriate signage and pavement markings in accordance with the aforementioned speed zones and no parking zones.

PASSED AND APPROVED THIS 4TH DAY OF MAY, 2010.







CITY OF LA VISTA

Douglas Kindig, Mayor

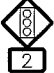
ATTEST:

Pamela Buethe, CMC
City Clerk

Parkview Elementary School

-  STOP SIGN
-  TRAFFIC SIGNAL HEAD
-  SCHOOL ADVANCE WARNING ASSEMBLY (S1-1 & W16-9p)
-  SCHOOL CROSSWALK WARNING ASSEMBLY (S1-1 & W16-7p)
-  SCHOOL SPEED LIMIT - 15
WHEN CHILDREN ARE PRESENT
FINES DOUBLE IN SCHOOL ZONE
-  SCHOOL SPEED LIMIT - 15
WHEN FLASHING
FINES DOUBLE IN SCHOOL ZONE
-  SCHOOL SPEED LIMIT - 40
WHEN FLASHING
FINES DOUBLE IN SCHOOL ZONE
-  END SCHOOL ZONE (S5-2)

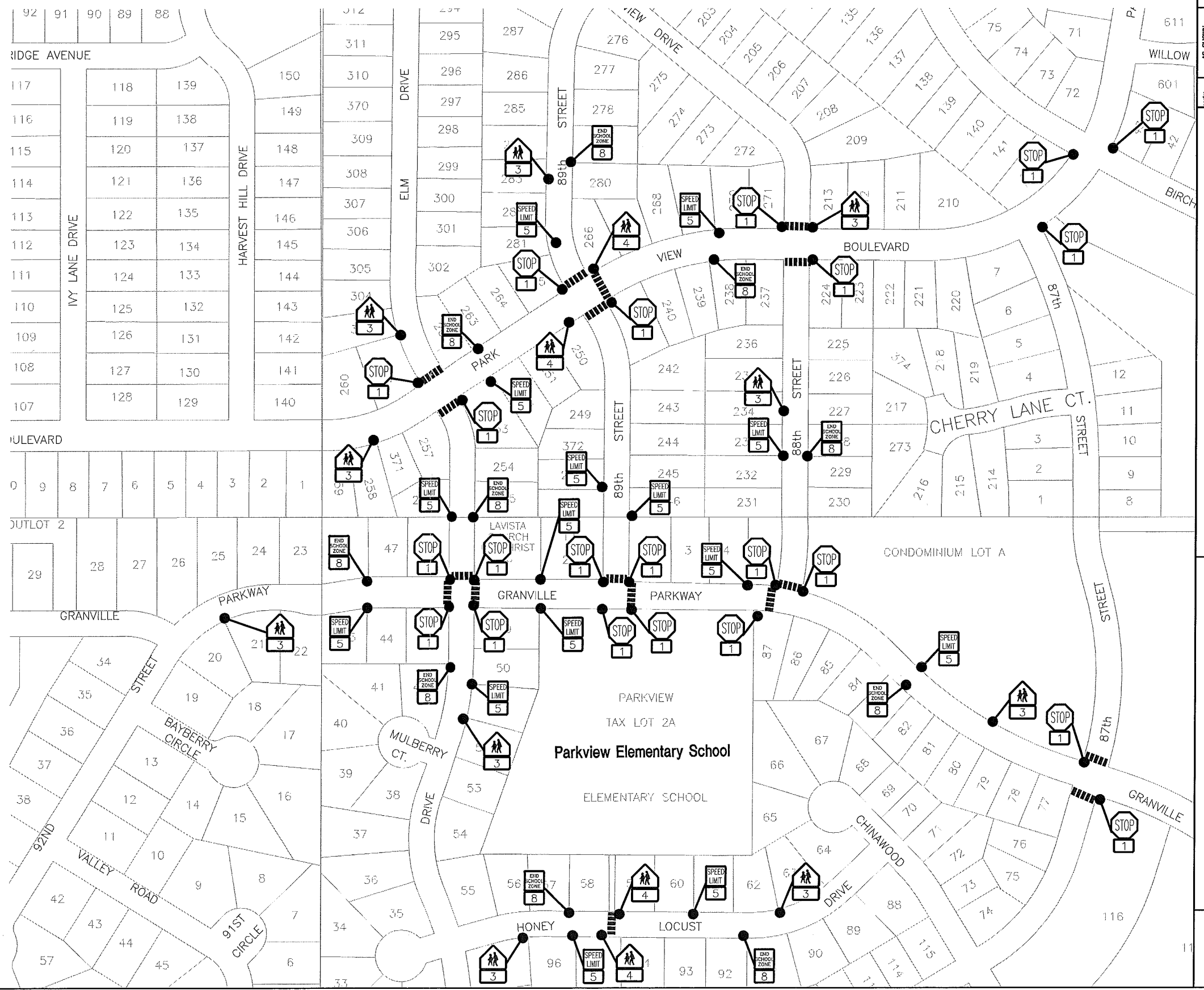
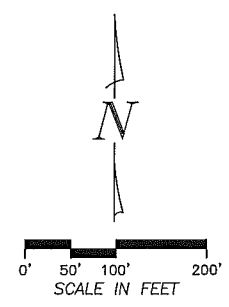

AS SHOWN		10-14-09	RTM	JMK	
DATE	BY	DATE	BY	DATE	BY

SCHOOL ACCESS ROUTE MAPS

PARKVIEW ELEMENTARY SCHOOL

CITY OF LA VISTA

2 THOMPSON, DREESSEN & DORNER, INC.
Consulting Engineers & Land Surveyors
10836 OLD MILL ROAD OMAHA, NEBRASKA 68154
PHONE: 402.330.8890 FAX: 402.330.8899 EMAIL: TDORNER@TDCO.COM
WEBSITE: WWW.TDCO.COM

171-362

SHEET 3 OF 6